

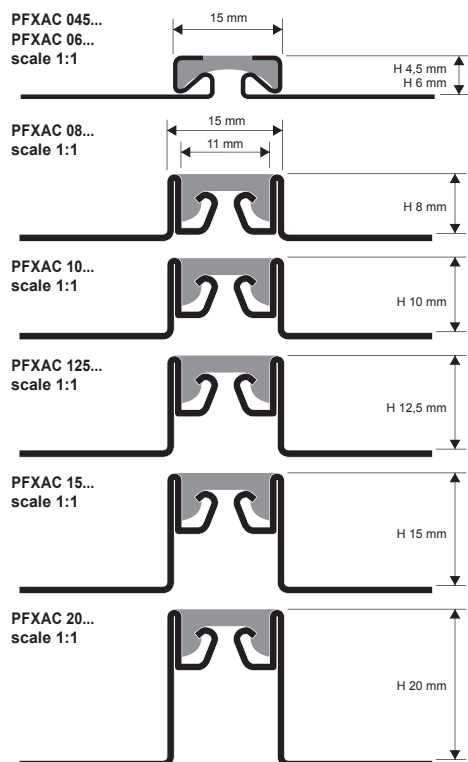

• movement and expansion joints

PROFLEX ACC

STAINLESS STEEL AISI 304/1.4301-V2A
+ VINYL RESIN / RUBBER INSERT



EXAMPLES OF LAYING

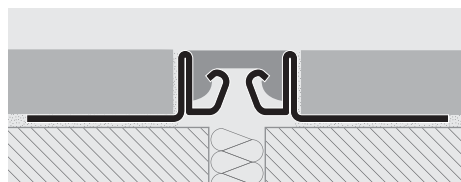

PROFLEX ACC is a new, stainless steel expansion joint with interchangeable (H. 4,5 e 6 mm excluded) vinyl resin/rubber insert, available in black, grey, beige or ivory. **PROFLEX ACC** provides elastic expansion joints for various kinds of flooring, such as ceramic, marble, granite, Kerilite/Laminam or any other flooring material laid with glue/adhesive and having a thickness of 4.5 to 20 mm. The joint is specially designed to protect the edges of the tiles, and its exceptional strength makes it capable of supporting frequent traffic, both pedestrian and vehicular (forklifts, pallet trucks, automobiles). The joint must be installed at the same level of the floor or 0.5-1 mm lower (never above).

HIGH RESISTANCE TO LOADS AND TO FREQUENT TRAFFIC OF PALLET TRUCKS AND FORKLIFTS.



VINYL RESIN/RUBBER INSERT

Article	H mm	€/LM	€/Pc
ISPFAC 820...	8-10-12,5-15-20	3,24	8,10



VINYL RESIN/RUBBER INSERT

Article	H mm	€/LM	€/Pc
ISPFAC 045...	4,5	2,98	7,45
ISPFAC 06...	6	2,98	7,45

Insert available in the colours: G - N (Beige and Ivory available upon request with a minimum quantity order of 500 LM).

The code of the selected colour must be added to the article code. E.g.: PFXAC 045... (chosen insert colour Grey) PFXAC 045G.

COLOURS

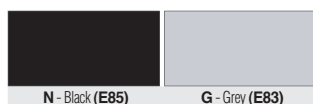

(price and delivery time to be agreed)

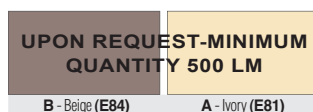

(for a precise assessment of colours and finishes, see the relative enclosed sheet)

SUITABLE FOR USE IN CONTACT WITH FOODSTUFFS

PROFLEX ALN is a new, natural aluminium expansion joint consisting of two interlocked sliding profiles designed for glued floors. **PROFLEX ALN** provides elastic expansion joints for various kinds of flooring, such as ceramic, marble, granite, Kerilite or any other flooring material laid with glue/adhesive and having a thickness of 8 to 20 mm. The joint is specially designed to protect the edges of the tiles, and its exceptional strength makes it capable of supporting frequent traffic, both pedestrian and vehicular (forklifts, pallet trucks, automobiles). The joint must be installed at the same level of the floor or 0.5-1 mm lower (never above). HIGH RESISTANCE TO LOADS AND TO FREQUENT TRAFFIC OF PALLET TRUCKS AND FORKLIFTS.

PROFLEX ALN

NATURAL ALUMINIUM

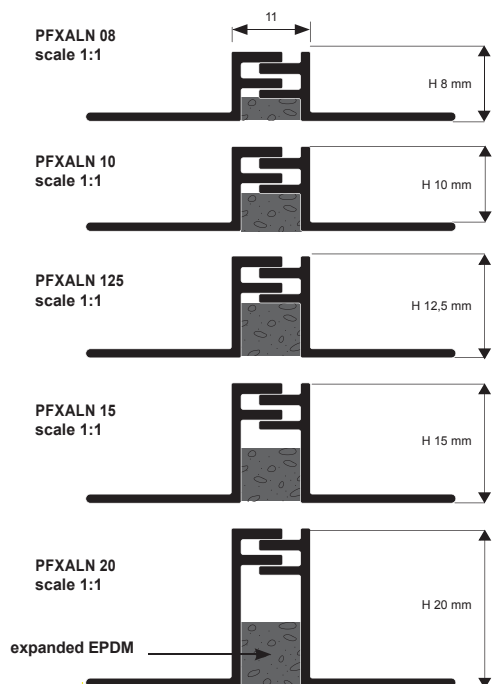

expanded EPDM



NATURAL ALUMINIUM

bar length 2,5 LM - pack. 20 Pcs - 50 LM

Article	H mm	€/LM	€/Pc
PFXALN 08	8	11,91	29,78
PFXALN 10	10	12,38	30,95
PFXALN 125	12,5	12,79	31,98
PFXALN 15	15	13,40	33,50
PFXALN 20	20	14,33	35,83

COLOURS



EXAMPLES AND INSTRUCTIONS FOR LAYING METHODS

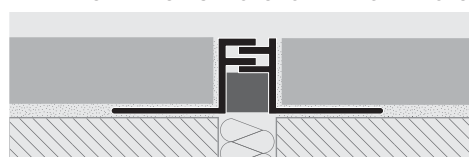

1. Choose the PROFLEX ALN with the same height as the thickness of the floor (tile). 2. Using a notched spreader apply the adhesive in the point where the joint will be laid. 3. Lay the PROFLEX ALN with the punched flanges in the adhesive (we recommend the expansion joint being laid in line with the joint in the screed/floor rough). 4. Lay the tiles, aligning them with and adjoining the upper edge of the profile (the joint must always be 0.5-1mm lower than the tile, never above). Always place the uncut side of the tile against the profile. 5. Use sealant to fill any spaces between the tile and the PROFLEX ALN joint.

PROFLEX AL is an expansion joint in natural aluminium with the PVC/rubber insert. It is available in black, grey, beige or ivory and serves to fabricate expansion joints for ceramic tile, marble or granite floors and any floor laid with glue/adhesive between 8 and 20 mm thick. The special structure of the joint is designed to protect the corners of the tiles and its high strength withstands frequent pedestrian and vehicular (lift trucks, pallet trucks, cars) traffic. The joint must be placed level with or 0.5-1 mm below the floor level, never above. HIGH RESISTANCE TO HEAVY LOADS AND TO FREQUENT PALLET TRUCK AND LIFT TRUCK TRAFFIC.

PROFLEX AL

NATURAL ALUMINIUM
+ VINYL RESIN / RUBBER INSERT



NATURAL ALUMINIUM + VINYL RESIN / RUBBER INSERT
bar length 2,5 LM - pack. 20 Pcs - 50 LM

Article	H mm	€/LM	€/Pc
PFXAL 08...	8	11,09	27,73
PFXAL 10...	10	11,30	28,25
PFXAL 125...	12,5	11,61	29,03
PFXAL 15...	15	12,27	30,68
PFXAL 20...	20	13,30	33,25

VINYL RESIN / RUBBER INSERT
bar length 2,5 LM - pack. 40 Pcs - 100 LM

Article	L x H mm	€/LM	€/Pc
IGCN (black)	14 x 6	3,74	9,35
IGCG (grey)	14 x 6	3,74	9,35
IGCB (beige)	14 x 6	3,74	9,35
IGCA (ivory)	14 x 6	3,74	9,35

Insert available in the colours: G - N (Beige and Ivory available upon request with a minimum quantity order of 500 LM).
The code of the selected colour must be added to the article code. E.g.: PFXAL 08... (chosen insert colour Grey) PFXAL 08G.

COLOURS

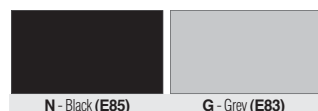

(for a precise assessment of colours and finishes, see the relative enclosed sheet)

(price and delivery time to be agreed)

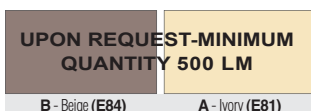

PROFLEX OT is an expansion joint in natural brass with the interchangeable PVC/rubber insert. It is available in black, grey, beige or ivory and serves to fabricate expansion joints for ceramic tile, marble or granite floors and any floor laid with glue/adhesive between 8 and 20 mm thick. The special structure of the joint is designed to protect the corners of the tiles and its high strength withstands frequent pedestrian and vehicular (lift trucks, pallet trucks, cars) traffic. The joint must be placed level with or 0.5-1 mm below the floor level, never above. HIGH RESISTANCE TO HEAVY LOADS AND TO FREQUENT PALLET TRUCK AND LIFT TRUCK TRAFFIC.

PROFLEX OT

NATURAL BRASS
+ VINYL RESIN / RUBBER INSERT



NATURAL BRASS + VINYL RESIN / RUBBER INSERT
bar length 2,5 LM - pack. 10 Pcs - 25 LM

Article	H mm	€/LM	€/Pc
PFXOT 08...	8	24,70	61,75
PFXOT 10...	10	25,88	64,70
PFXOT 125...	12,5	27,32	68,30
PFXOT 15...	15	28,96	72,40
PFXOT 20...	20	31,79	79,48
PFXOT 30...	30	34,20	85,50

VINYL RESIN / RUBBER INSERT
bar length 2,5 LM - pack. 40 Pcs - 100 LM

Article	L x H mm	€/LM	€/Pc
IGCN (black)	14 x 6	3,74	9,35
IGCG (grey)	14 x 6	3,74	9,35
IGCB (beige)	14 x 6	3,74	9,35
IGCA (ivory)	14 x 6	3,74	9,35

Insert available in the colours: G - N (Beige and Ivory available upon request with a minimum quantity order of 500 LM).
The code of the selected colour must be added to the article code. E.g.: PFXOT 08... (chosen insert colour Grey) PFXOT 08G.

COLOURS

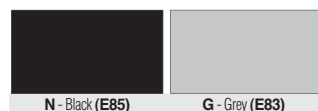

(for a precise assessment of colours and finishes, see the relative enclosed sheet)

(price and delivery time to be agreed)

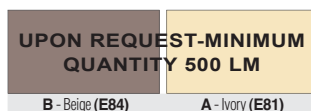

PFXAL/OT 08

scale 1:1

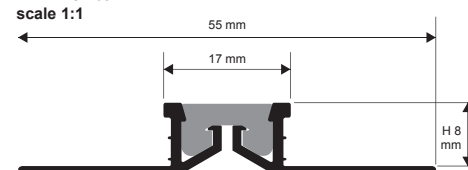

PFXAL/OT 10

scale 1:1



PFXAL/OT 125

scale 1:1



PFXAL/OT 15

scale 1:1



PFXAL/OT 20

scale 1:1



PFXOT 30

scale 1:1

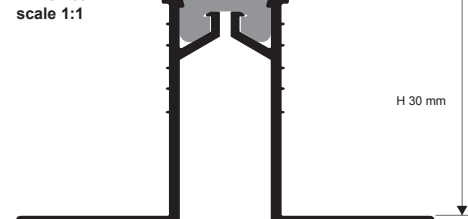

EXAMPLES AND INSTRUCTIONS FOR LAYING METHODS

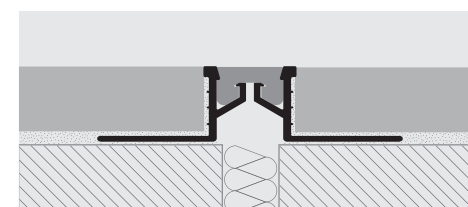

1. Choose the PROFLEX AL - OT with the same height as the thickness of the floor (tile) also choosing the colour of the insert. 2. Using a notched spreader apply the adhesive in the point where the joint will be laid. 3. Lay the PROFLEX AL - OT with the punched flanges in the adhesive (we recommend the expansion joint being laid in line with the joint in the screed/floor rough). 4. Lay the tiles, aligning them with and adjoining the upper edge of the profile (the joint must always be 0.5-1mm lower than the tile, never above). Always place the uncured side of the tile against the profile. 5. Use sealant to fill any spaces between the tile and the PROFLEX AL - OT joint.

PROFLEX

NON-TOXIC IMPACT-RESISTANT
CO-EXTRUDED VINYL RESIN (PVC)

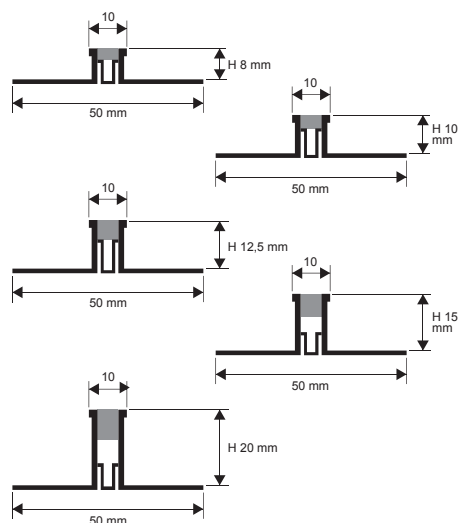

EXAMPLES AND INSTRUCTIONS FOR LAYING METHODS

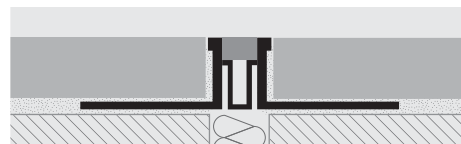

1. Choose the PROFLEX with suitable height for the thickness of the floor. 2. Apply the adhesive onto the area of application of the profile. 3. Lay and align the profile, cut to the necessary length, pressing the perforated flange into the adhesive. 4. Lay the tiles, aligning them so that the top edge of the profile is flush with the tile. 5. Fill the profile/tile area of contact with adhesive to prevent the accumulation of water in any voids.

PROFLEX is an expansion joint in PVC with PVC/rubber insert. Available in 3 standard colours, **PROFLEX** serves to fabricate expansion joints for ceramic tile, marble or granite floors and any floor laid with glue/adhesive between 8 and 20 mm thick. The special structure of the joint is designed to protect the corners of the tiles and its high strength withstands frequent pedestrian and vehicular (lift trucks - pallet trucks - cars) traffic. The joint must be placed level with or 0.5-1 mm below the floor level, never above. HIGH RESISTANCE TO HEAVY LOADS AND TO FREQUENT PALLET TRUCK AND LIFT TRUCK TRAFFIC.



NON-TOXIC CO EXTRUDED VINYL RESIN

bar length 2,5 LM - pack. 40 Pcs - 100 LM (PFX 15 and PFX 20 - pack. 20 Pcs)

Article	H mm	€/LM	€/Pc
PFX 08...	8	3,13	7,83
PFX 10...	10	3,44	8,60
PFX 125...	12,5	3,75	9,38
PFX 15...	15	4,16	10,40
PFX 20...	20	4,98	12,45

Available in the colours: GS-GT-GL (Beige and Ivory available upon request with a minimum quantity order of 500 LM). The code of the selected colour must be added to the article code. E.g.: PFX 08... (chosen colour Dark Grey) PFX 08GS.

COLOURS

GS - Dark grey for rigid and flexible part	GT - Dark grey for rigid part / Transparent for flexible part	GL - Light grey for rigid and flexible part

(for a precise assessment of colours and finishes, see the relative enclosed sheet)

(price and delivery time to be agreed)

UPON REQUEST-MINIMUM QUANTITY 500 LM	
B - Beige (E84)	A - Ivory (E81)

PROFLEX 5

NON-TOXIC IMPACT-RESISTANT
CO-EXTRUDED VINYL RESIN (PVC)

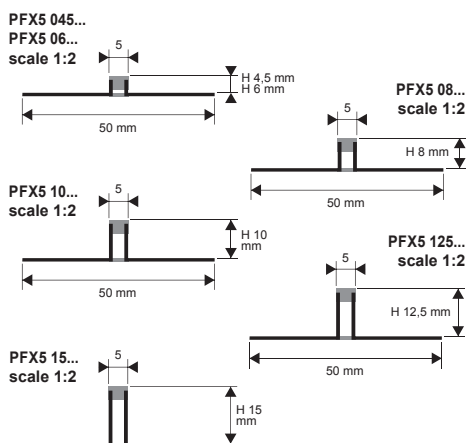

EXAMPLES AND INSTRUCTIONS FOR LAYING METHODS

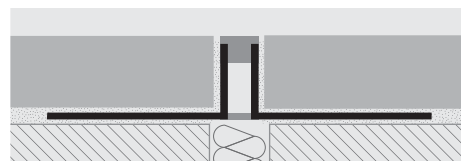

1. Choose the PROFLEX 5 with suitable height for the thickness of the floor. 2. Apply the adhesive onto the area of application of the profile. 3. Lay and align the profile, cut to the necessary length, pressing the perforated flange into the adhesive. 4. Lay the tiles, aligning them so that the top edge of the profile is flush with the tile. 5. Fill the profile/tile area of contact with adhesive to prevent the accumulation of water in any voids.

PROFLEX 5 is a range of technical expansion joint profiles for floors laid with glue/adhesive. They are made in non-toxic, impact-resistant, co-extruded PVC with perforated horizontal lateral flanges in rigid PVC while the elastic central part is made in flexible vinyl resin 5 mm in width. They are able to absorb moderate tensile and compressive stress, while being resistant to most chemical agents, to wear and to UV rays. They may be used indoors and outdoors. Thanks to the limited widths, **PROFLEX 5** may be considered a "gap cover" because it blends in with the gaps between tiles. The joint profile must never be placed over a tiled floor and should preferably always be 0.5-1 mm lower. Recommended modules of application 16-30 m².



NON-TOXIC CO EXTRUDED VINYL RESIN

bar length 2,5 LM - pack. 40 Pcs - 100 LM (PFX5 15 - pack 20 Pc - 50 LM)

Article	H mm	€/LM	€/Pc
PFX5 045...	4,5	2,46	6,15
PFX5 06...	6	2,67	6,68
PFX5 08...	8	2,77	6,93
PFX5 10...	10	3,08	7,70
PFX5 125...	12,5	3,34	8,35
PFX5 15...	15	3,59	8,98

Available in the colours: GS-GL (Beige and Ivory available upon request with a minimum quantity order of 500 LM). The code of the selected colour must be added to the article code. E.g.: PFX5 08... (chosen colour Dark Grey) PFX5 08GS.

COLOURS

GS - Dark grey for rigid and flexible part	GL - Light grey for rigid and flexible part

(for a precise assessment of colours and finishes, see the relative enclosed sheet)

(price and delivery time to be agreed)

UPON REQUEST-MINIMUM QUANTITY 1000 LM per colour and height	
B - Beige (E84)	A - Ivory (E81)



PRODILAT

STAINLESS STEEL AISI 304/1.4301-V2A
WITH SANDABLE VULCANIZED EPDM

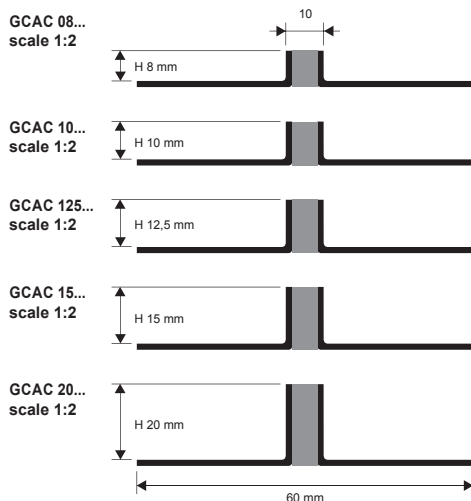

EXAMPLES AND INSTRUCTIONS FOR LAYING METHODS

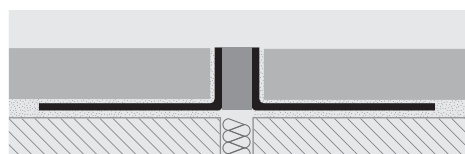

1. Choose the PRODILAT with the same height as the thickness of the floor (tile) also choosing the colour of the insert. 2. Using a notched spreader apply the adhesive in the point where the joint will be laid. 3. Lay the PRODILAT with the punched flanges in the adhesive (we recommend the expansion joint being laid in line with the joint in the screed/floor rough). 4. Lay the tiles, aligning them with and adjoining the upper edge of the profile (the joint must always be 0.5-1mm lower than the tile, never above). Always place the uncut side of the tile against the profile. 5. Use sealant to fill any spaces between the tile and the PRODILAT.

The **PRODILAT** for laying with adhesive are available in stainless steel. The inside part of the joint is always in black or grey vulcanised expanded neoprene. The joint is designed to withstand heavy loads and frequent foot traffic. Install the joint in line with the cut made in the concrete screed. High strength, high quality joint.



STAINLESS STEEL AISI 304/1.4301-V2A with SANDABLE VULCANIZED EPDM - bar length 2,7 LM - pack. 20 Pcs - 54 LM (GCAC 20 - 27 ML)

Article	H mm	€/LM	€/Pc
GCAC 08... (8x10)	8	34,71	93,72
GCAC 10... (10x10)	10	36,15	97,61
GCAC 125... (12,5x10)	12,5	39,13	105,65
GCAC 15... (15x10)	15	41,29	111,48
GCAC 20... (20x10)	20	47,60	128,52

Insert available in the colours: G - B - N.
The code of the selected colour must be added to the article code.
E.g.: GCAC 08... (chosen insert colour Grey) GCAC 08G.

COLOURS

(for a precise assessment of colours and finishes, see the relative enclosed sheet)

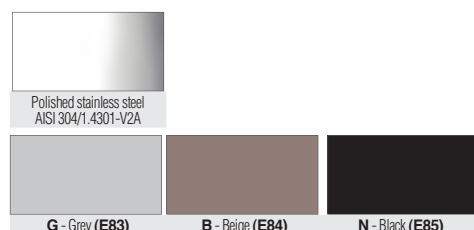

PRODILAT

ALUMINIUM WITH
SANDABLE VULCANIZED EPDM

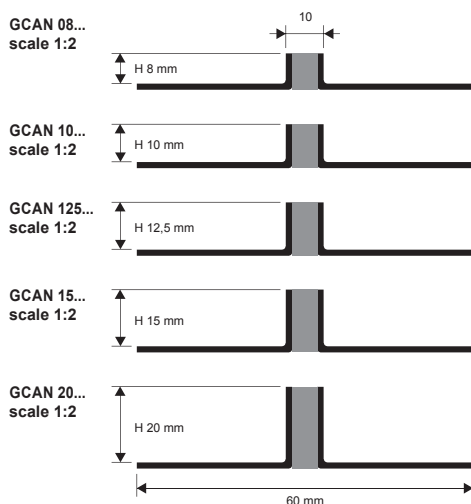

EXAMPLES OF LAYING (for laying instructions, see upstairs)

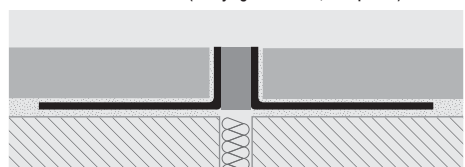

The **PRODILAT** for laying with adhesive are available in aluminium. The inside part of the joint is always in black or grey vulcanised expanded neoprene. The joint is designed to withstand heavy loads and frequent foot traffic. Install the joint in line with the cut made in the concrete screed. High strength, high quality joint.



ALUMINIUM with SANDABLE VULCANIZED EPDM
bar length 2,7 LM - pack. 20 Pcs - 54 LM

Article	H mm	€/LM	€/Pc
GCAN 08... (8x10)	8	22,75	61,43
GCAN 10... (10x10)	10	23,52	63,50
GCAN 125... (12,5x10)	12,5	25,01	67,53
GCAN 15... (15x10)	15	26,60	71,82
GCAN 20... (20x10)	20	29,68	80,14

Insert available in the colours: N - G - A.
The code of the selected colour must be added to the article code.
E.g.: GCAN 08... (chosen insert colour Grey) GCAN 08G.

COLOURS



(for a precise assessment of colours and finishes, see the relative enclosed sheet)

Prices are referred to whole packs. 10% increase for minimum orders of 10 pcs. 20% increase for orders of less than 10 pcs.

PROFLEX 25 H 25 mm is a new expansion joint made of coextruded vinyl resin available in two standard colours – dark grey (GS) and light grey (GL). **PROFLEX 25** H 25 mm provides elastic expansion joints for various kinds of flooring, such as marble or granite, and especially floors made with Sasso Italia. The new decorative indoor and outdoor flooring also known as SASSO ITALIA is approx. 25 mm thick and laid over a 10-20 mm base of cement/concrete. This kind of floor needs an expansion/control joint every 16-30 m² of material to avoid cracking caused by the floor's expansion. **PROFLEX** H 25 mm lets you place a GP 20 EXTENSION JOINT at the bottom in order to apply/lay the joint inside the concrete base. It can withstand the frequent passage of pedestrians and vehicles (forklifts, pallet trucks, automobiles). The joint must be installed at the same level of the floor or 0.5-1 mm lower (never above). HIGH RESISTANCE TO LOADS AND TO FREQUENT TRAFFIC OF PALLET TRUCKS AND FORKLIFTS.



CO EXTRUDED VINYL RESIN

bar length 2,5 LM - pack. 20 Pcs - 50 LM

Article	H mm	€/LM	€/Pc
PFXGP 45... (assembled Art.)	45	8,52	21,30
PFX 25...	25	6,52	16,30
GP 20	20	1,16	2,90

Available in the colours: GS - GL. The code of the selected colour must be added to the article code. E.g.: PFX 25 .. (chosen colour Dark Grey) PFX 25GS.

COLOURS



(for a precise assessment of colours and finishes, see the relative enclosed sheet)

EXAMPLES OF LAYING

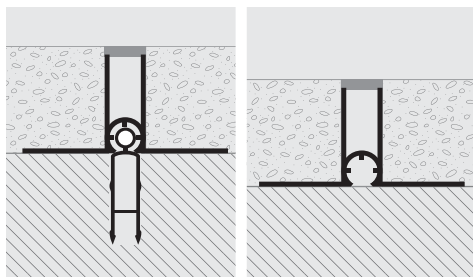

LAYING INSTRUCTIONS

1. Choose the colour of the joint. 1a: For the version with the extension, insert it onto the fresh cement base leaving the cylindrical part out, for subsequent fitting with PROFLEX 25. 2. Place and fix with screws/nails to the cement floor and snap the PROFLEX 25 into protruding extension. 3. Begin laying the floor from the inside, near the joint aligning it with the edges. 4. Finish laying the floor by levelling the joint with the floor. 5. Plaster the gap between floor and joint with specific mortar.

PROFLEX 25

NON-TOXIC IMPACT-RESISTANT
CO-EXTRUDED VINYL RESIN

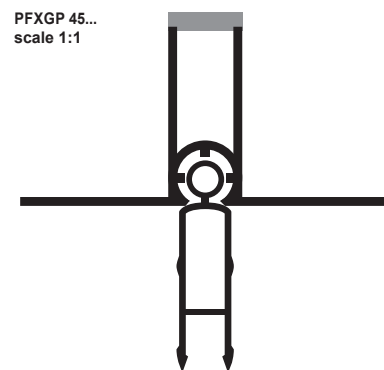
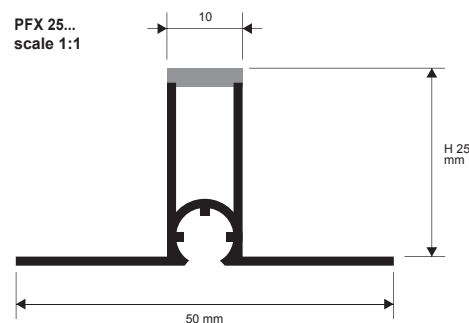

PROFLEX ACC is a new, stainless steel expansion joint with interchangeable Vinyl Resin/Rubber insert, available in Black or Grey. **PROFLEX ACC** provides elastic expansion joints for various kinds of flooring: Kerilite/ Laminam, thin ceramic tile and any other flooring material laid with glue/adhesive and having a thickness of 4.5 to 6 mm. The joint is specially designed to protect the edges of the tiles, and its exceptional strength makes it capable of supporting frequent traffic, both pedestrian and vehicular (forklifts - pallet trucks - automobiles). The joint must be installed at the same level of the floor or 0.5-1 mm lower, never above the flooring. HIGH RESISTANCE TO LOADS AND TO FREQUENT TRAFFIC OF PALLET TRUCKS AND FORKLIFTS.

STAINLESS STEEL AISI 304/1.4301- V2A + VINYL RESIN/ RUBBER INSERT - bar length 2,5 LM - pack. 20 Pcs - 50 LM

Article	H mm	€/LM	€/Pc
PFXAC 045...	4,5	19,82	49,55
PFXAC 06...	6	20,64	51,60

VINYL RESIN/RUBBER INSERT

Article	H mm	€/LM	€/Pc
ISPFAC 045...	4,5	2,98	7,45
ISPFAC 06...	6	2,98	7,45

Insert available in the colours: G - N (Beige and Ivory available upon request with a minimum quantity order of 500 LM). The code of the selected colour must be added to the article code. E.g.: PFXAC 045... (chosen insert colour Grey) PFXAC 045G.

SUITABLE FOR USE IN CONTACT WITH FOODSTUFFS

COLOURS

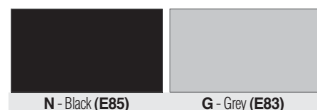

(for a precise assessment of colours and finishes, see the relative enclosed sheet)

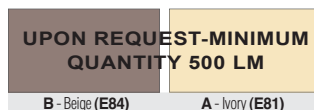

(price and delivery time to be agreed)

UPON REQUEST-MINIMUM
QUANTITY 500 LM

B - Beige (E84) A - Ivory (E81)

PROFLEX ACC

STAINLESS STEEL AISI 304/1.4301-V2A
+ VINYL RESIN / RUBBER INSERT



PFXAC 045...
PFXAC 06...
scale 1:1

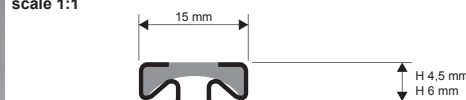

EXAMPLES AND INSTRUCTIONS FOR LAYING METHODS

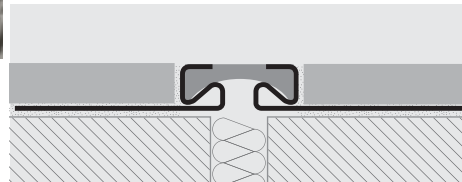

1. Choose the PROFLEX ACC with the same height as the thickness of the floor (tile) also choosing the colour of the insert. 2. Using a notched spreader apply the adhesive in the point where the joint will be laid. 3. Lay the PROFLEX ACC with the punched flanges in the adhesive (we recommend the expansion joint being laid in line with the joint in the screed/floor rough). 4. Lay the tiles, aligning them with and adjoining the upper edge of the profile (the joint must always be 0.5-1mm lower than the tile, never above). Always place the uncut side of the tile against the profile. 5. Use sealant to fill any spaces between the tile and the PROFLEX ACC joint.

joints for low thicknesses

PROFLEX 5

NON-TOXIC IMPACT-RESISTANT
CO-EXTRUDED VINYL RESIN (PVC)

joints for low thicknesses

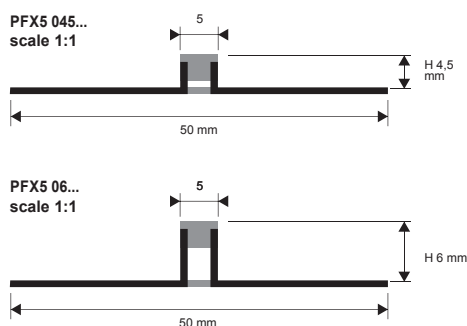

EXAMPLES AND INSTRUCTIONS FOR LAYING METHODS

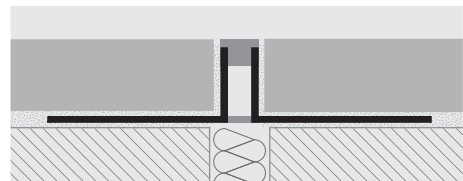

1. Choose the PROFLEX 5 with suitable height for the thickness of the floor. 2. Apply the adhesive onto the area of application of the profile. 3. Lay and align the profile, cut to the necessary length, pressing the perforated flange into the adhesive. 4. Lay the tiles, aligning them so that the top edge of the profile is flush with the tile. 5. Fill the profile/tile area of contact with adhesive to prevent the accumulation of water in any voids.

PROFLEX 5 is a range of technical expansion joint profiles for floors, thin ceramic tile: Kerilite/ Laminam, laid with glue/adhesive. They are made in non-toxic, impact-resistant, co-extruded PVC with perforated horizontal lateral flanges in rigid PVC while the elastic central part is made in flexible vinyl resin 5 mm in width. They are able to absorb moderate tensile and compressive stress, while being resistant to most chemical agents, to wear and to UV rays. They may be used indoors and outdoors. Thanks to the limited widths, **PROFLEX 5** may be considered a "gap cover" because it blends in with the gaps between tiles. The joint profile must never be placed over a tiled floor and should preferably always be 0.5-1 mm lower. Recommended modules of application 16-30 m². Available in dark grey and light grey and in various heights H 4,5 and 6 mm.



NON-TOXIC CO-EXTRUDED VINYL RESIN
bar length 2,5 LM - pack. 40 Pcs - 100 LM

Article	H mm	€/LM	€/Pc
PFX5 045...	4,5	2,46	6,15
PFX5 06...	6	2,67	6,68

Available in the colours: GS-GL (Beige and Ivory available upon request with a minimum quantity order of 500 LM). The code of the selected colour must be added to the article code. E.g.: PFX5 045... (chosen colour Dark Grey) PFX5 045GS.

COLOURS



(price and delivery time to be agreed)

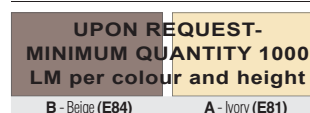

(for a precise assessment of colours and finishes, see the relative enclosed sheet)

PROFLEX 5 PR

NON-TOXIC IMPACT-RESISTANT
CO-EXTRUDED VINYL RESIN (PVC)

joints for low thicknesses

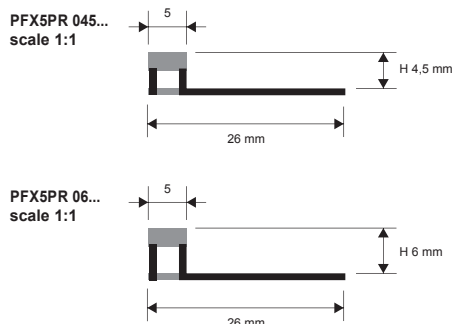

EXAMPLES AND INSTRUCTIONS FOR LAYING METHODS

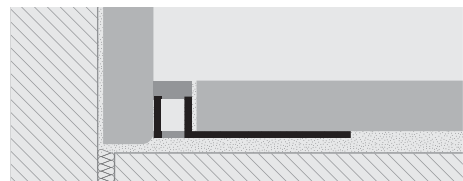

1. Choose the PROFLEX 5 PR with suitable height for the thickness of the floor. 2. Apply the adhesive onto the area of application of the profile. 3. Lay and align the profile, cut to the necessary length, pressing the perforated flange into the adhesive. 4. Lay the tiles, aligning them so that the top edge of the profile is flush with the tile. 5. Fill the profile/tile area of contact with adhesive to prevent the accumulation of water in any voids.

PROFLEX 5 PR is a perimeter joint made of coextruded vinyl resin that can be used to connect the floor to the wall lining or the wall lining to doors and windows and/or to any other kind of lining. The 5 mm elastic part (exposed) allows the floor/lining to expand as necessary.

PROFLEX 5 PR prevents and dampens the propagation of sound waves and the forming of sound bridges. Available in dark grey and light grey and in various heights H 4,5 and 6 mm.



VINYL RESIN - bar length 2,5 LM - pack. 40 Pcs - 100 LM

Article	H mm	€/LM	€/Pc
PFX5PR 045...	4,5	2,46	6,15
PFX5PR 06...	6	2,67	6,68

Available in the colours: GS-GL (Beige and Ivory available upon request with a minimum quantity order of 500 LM). The code of the selected colour must be added to the article code. E.g.: PFX5PR 045... (chosen insert colour Dark Grey) PFX5PR 045GS.

COLOURS

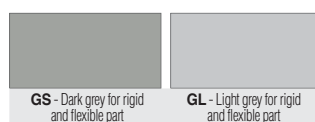

(price and delivery time to be agreed)

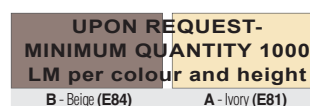

(for a precise assessment of colours and finishes, see the relative enclosed sheet)

PROFLEX ACC PR is a new perimeter joint made of AISI 304/1.4301-V2A stainless steel, with an interchangeable vinyl resin/ rubber insert. **PROFLEX ACC PR** is applied on fixed parts, such as doors, windows and frames, and also on ceramic tiling, plaster and vertical walls. The visible part of the perimeter joint is the same as **PROFLEX ACC**, with an exposed steel flange. **PROFLEX ACC PR** joints prevent sound from propagating through the wall lining and reduce the transmission of noise caused by footfalls and vibrations. Available with grey (G), black (N), beige (B) or ivory (A) inserts and in various heights H 8-10-12,5-15-20 mm.

PROFLEX ACC PR

STAINLESS STEEL AISI 304/1.4301-V2A
+ VINYL RESIN / RUBBER INSERT



POLISHED STAINLESS STEEL AISI 304/1.4301- V2A + VINYL RESIN / RUBBER INSERT
bar length 2,5 LM - pack. 20 Pcs - 50 LM

Article	H mm	€/LM	€/Pc
PFXACPR 08...	8	17,10	42,75
PFXACPR 10...	10	17,30	43,25
PFXACPR 125...	12,5	17,87	44,68
PFXACPR 15...	15	18,54	46,35
PFXACPR 20...	20	19,67	49,18

COLOURS



(price and delivery time to be agreed)

UPON REQUEST-MINIMUM QUANTITY 500 LM

B - Beige (E84)

A - Ivory (E81)

(for a precise assessment of colours and finishes, see the relative enclosed sheet)



VINYL RESIN / RUBBER INTERCHANGEABLE INSERT

Article	H mm	€/LM	€/Pc
INPFXACR 820	8-10-12,5-15-20	3,24	8,10

Insert available in the colours: G - N (Beige and Ivory available upon request with a minimum quantity order of 500 LM). The code of the selected colour must be added to the article code. E.g.: PFXACPR 08... (chosen insert colour Grey) PFXACPR 08G.

EXAMPLES AND INSTRUCTIONS FOR LAYING METHODS

1. Choose the PROFLEX ACC PR with suitable height for the thickness of the floor. 2. Apply the adhesive onto the area of application of the profile. 3. Lay and align the profile, cut to the necessary length, pressing the perforated flange into the adhesive. 4. Lay the tiles, aligning them so that the top edge of the profile is flush with the tile. 5. Fill the profile/tile area of contact with adhesive to prevent the accumulation of water in any voids.

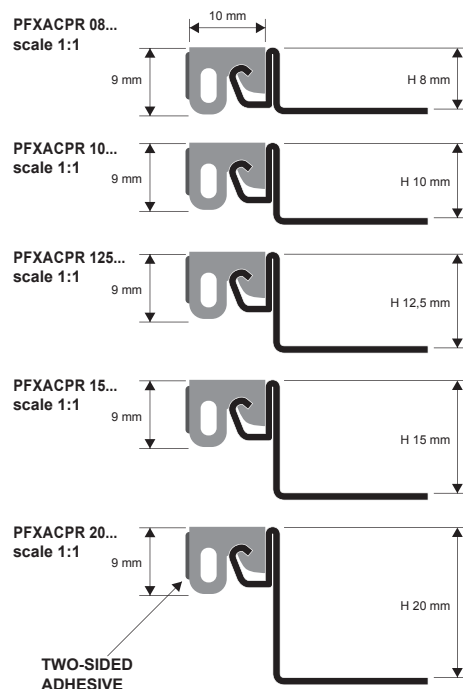

EXAMPLES OF LAYING

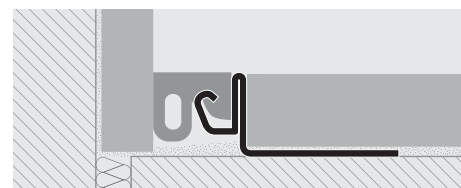

soundproof perimeter joints

movement and expansion joints

SUITABLE FOR USE IN CONTACT WITH FOODSTUFFS

PROFLEX 5 PR is a perimeter joint made of coextruded vinyl resin that can be used to connect the floor to the wall lining or the wall lining to doors and windows and/or to any other kind of lining. The 5 mm elastic part (exposed) allows the floor/lining to expand as necessary. **PROFLEX 5 PR** prevents and dampens the propagation of sound waves and the forming of sound bridges. Available in dark grey, light grey, Beige and Ivory, in various heights H 4,5-6-8-10-12,5 mm.



EXAMPLES OF LAYING (for laying instructions, see PROFLEX ACC PR)

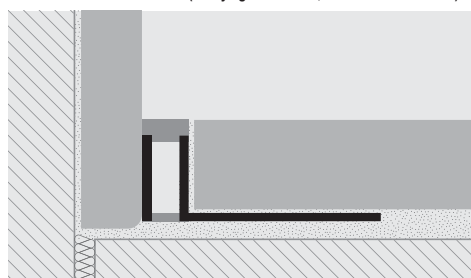

Insert available in the colours: GS-GL (Beige and Ivory available upon request with a minimum quantity order of 500 LM). The code of the selected colour must be added to the article code. E.g.: PFX5PR 045... (chosen insert colour Dark Grey) PFX5PR 045GS.

VINYL RESIN - bar length 2,5 LM - pack. 40 Pcs - 100 LM

Article	H mm	€/LM	€/Pc
PFX5PR 045...	4,5	2,46	6,15
PFX5PR 06...	6	2,67	6,68
PFX5PR 08...	8	2,77	6,93
PFX5PR 10...	10	3,08	7,70
PFX5PR 125...	12,5	3,34	8,35
PFX5PR 15...	15	3,59	8,98

COLOURS



(for a precise assessment of colours and finishes, see the relative enclosed sheet)

(price and delivery time to be agreed)

UPON REQUEST-MINIMUM QUANTITY 1000 LM per colour and height
B - Beige (E84) A - Ivory (E81)

PROFLEX 5 PR

NON-TOXIC IMPACT-RESISTANT CO-EXTRUDED VINYL RESIN (PVC)

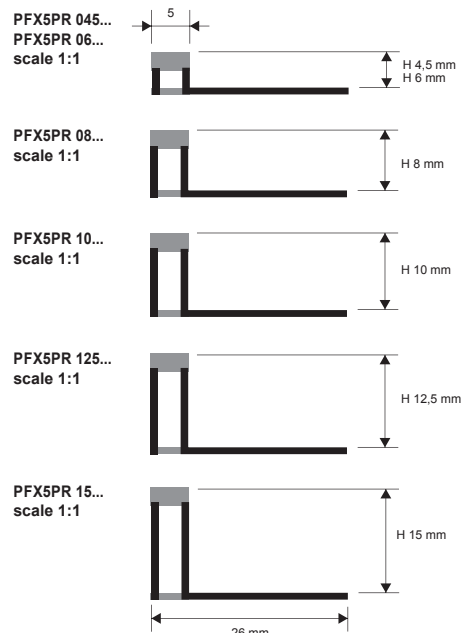

soundproof perimeter joints

ADHESIVE-LAID JOINTS

CO-EXTRUDED VINYL RESIN
3 COLOURS

movement joints

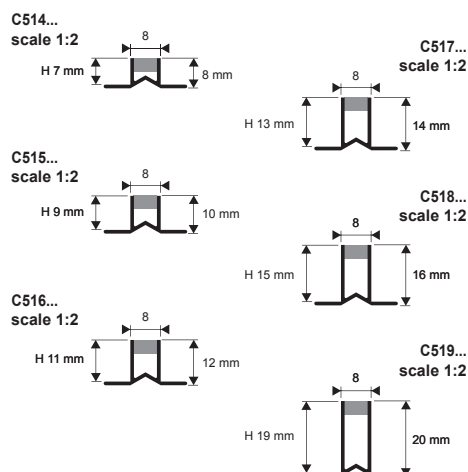

EXAMPLES AND INSTRUCTIONS FOR LAYING METHODS

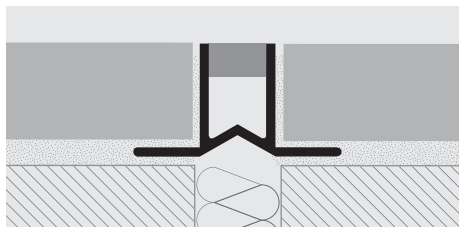

1. Choose the joint in accordance with the colour and thickness of the floor, calculating 0.5-1 mm less for laying the joint, which under no circumstances must protrude. 2. Place the joint over the cut/joint in the screed; if there is none, make a cut of 2/3 the thickness of the screed. 3. Apply the adhesive and lay the joint, pressing it into the glue. 4. Lay the tiles, aligning them with the rigid vertical part of the joint. 5. Using the special glue, fill the gap between the tiles and the profile.

ADHESIVE-LAID MOVEMENT JOINTS are a range of joints in co-extruded vinyl resin with the flanges and vertical supports made in rigid synthetic vinyl resin and the elastic central part in flexible synthetic vinyl resin. The glue-laid joints must be placed at least 0.5-1 mm below the level of the flooring (usually tiles) and never above. Suitable for pedestrian traffic, they absorb compressive and slip stress. Laying modules between 16 and 30 m² inclusive are recommended and the joint laid in line with the joints in the underlying screed. Available in various colours and heights.



CO - EXTRUDED VINYL RESIN

bar length 2,5 LM - pack. 40 Pcs - 100 LM

Article	H mm	€/LM	€/Pc
C 514... (8x8)	7	0,81	2,03
C 515... (10x8)	9	0,90	2,25
C 516... (12x8)	11	1,01	2,53
C 517... (14x8)	13	1,11	2,78
C 518... (16x8)	15	1,23	3,08
C 519... (20x8)	19	1,67	4,18

ARTICLES NOT FOR SALE SINGLY

Available combinations: GS-GT-GL (RT-MT-B and N available upon request with a minimum quantity order of 1.000 LM). The code of the selected colour must be added to the article code. E.g.: C514... (combination chosen colour Dark Grey / Transparent) C 514GT.

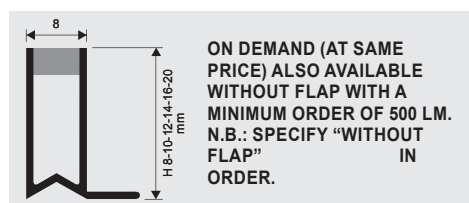

MORTAR-LAID MOVEMENT JOINTS are a range of joints in co-extruded vinyl resin with the flanges and vertical supports made in rigid synthetic vinyl resin and the elastic central part in flexible synthetic vinyl resin. The mortar-laid joints must be placed at least 0.5-1mm below the level of the ceramic tile-marble-granite floor and never above. Suitable for pedestrian traffic, they absorb compressive and slip stress.

Laying modules between 16 and 30 m² inclusive are recommended and the joint laid in line with the joints in the underlying screed. Available in various colours and heights.

MORTAR-LAID JOINTS

CO-EXTRUDED VINYL RESIN
3 COLOURS

movement joints

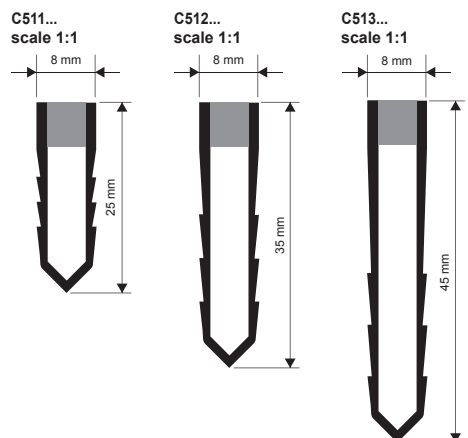

EXAMPLES OF LAYING

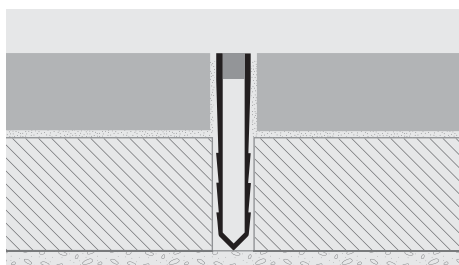

CO - EXTRUDED VINYL RESIN

bar length 2,5 LM - pack. 40 Pcs - 100 LM (C513 - pack. 50 LM)

Article	L x H mm	€/LM	€/Pc
C511...	8 x 25	1,27	3,18
C512...	8 x 35	1,48	3,70
C513...	8 x 45	1,85	4,63

ARTICLES NOT FOR SALE SINGLY

Available combinations: GS - GT - GL. The code of the selected colour must be added to the article code. E.g.: C511... (combination chosen colour Dark Grey / Transparent) C 511GT.



COLOURS

GS - Dark grey for rigid and flexible part	GT - Dark grey for rigid part / Transparent for flexible part	GL - Light grey for rigid and flexible part
---	--	--

(price and delivery time to be agreed)

UPON REQUEST - MINIMUM QUANTITY 1000 LM per colour and height		
RT - Red for rigid part / Transparent for flexible part	MT - Brown for rigid part / Transparent for flexible part	B - White for rigid and flexible part
N - Black for rigid and flexible part		

(for a precise assessment of colours and finishes, see the relative enclosed sheet)

COLOURS

GS - Dark grey for rigid and flexible part	GT - Dark grey for rigid part / Transparent for flexible part	GL - Light grey for rigid and flexible part
---	--	--

(price and delivery time to be agreed)

UPON REQUEST - MINIMUM QUANTITY 1000 LM per colour and height		
RT - Red for rigid part / Transparent for flexible part	MT - Brown for rigid part / Transparent for flexible part	B - White for rigid and flexible part
N - Black for rigid and flexible part		

(for a precise assessment of colours and finishes, see the relative enclosed sheet)

EXAMPLES AND INSTRUCTIONS FOR LAYING METHODS

1. Choose the colour and the necessary height of the joint, calculating the thickness of the finished floor and the thickness of the screed. 2. Insert the joint into the screed letting it protrude slightly (STAGE 1-2-3). 3. Proceed with laying the floor, aligning it with the rigid vertical part of the joint. 4. Complete laying by levelling the joint with the floor. 5. Using the mortar, grout the gap between the tiles and the profile.

THE MOVEMENT JOINT has been specially created to relieve the stress in prestige floors (marble, granite, ceramic tiles or wood) laid on a mortar bed. The joint is simply inserted by hand and is levelled with a plastic hammer. It is available in brass and stainless steel with internal vulcanised expanded EPDM gasket. Strong, practical and top quality.



POLISHED BRASS WITH SANDABLE VULCANIZED EPDM
bar length 2 LM - pack. 25 Pcs - 50 LM (GOT 20... - 20 ML)

Article	L x H mm	€/LM	€/Pc
GOT 20...	10 x 20	36,62	73,24
GOT 40...	10 x 40	62,77	125,54

Insert available in the colours: G - N - B (Ivory available upon request with a minimum quantity order of 500 LM).
The code of the selected colour must be added to the article code.
E.g.: GOT 20... (chosen insert colour Grey) GOT 20G.

Upon request, delivery time to be agreed.

COLOURS

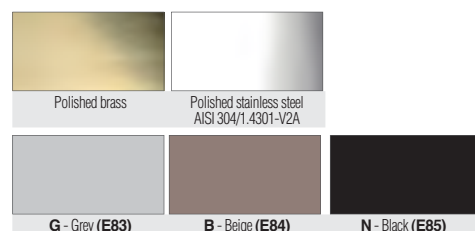

POLISHED STAINLESS STEEL AISI 304/1.4301-V2A WITH SANDABLE VULCANIZED EPDM
bar length 2 LM - pack. 25 Pcs - 50 LM (GAC 40... - 40 ML)

Article	L x H mm	€/LM	€/Pc
GAC 20...	10 x 20	34,47	68,94
GAC 40...	10 x 40	49,09	98,18

Insert available in the colours: G - N - B (Ivory available upon request with a minimum quantity order of 500 LM).
The code of the selected colour must be added to the article code.
E.g.: GAC 20... (chosen insert colour Grey) GAC 20G.

(price and delivery time to be agreed)

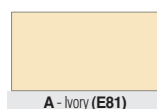

UPON REQUEST-MINIMUM QUANTITY 500 LM

(for a precise assessment of colours and finishes, see the relative enclosed sheet)

MORTAR-LAID JOINTS

POLISHED BRASS - STAINLESS STEEL AISI 304/1.4301-V2A WITH SANDABLE VULCANIZED EPDM

GOT/AC 20...
scale 1:1

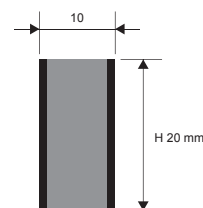

GOT/AC 40...
scale 1:1

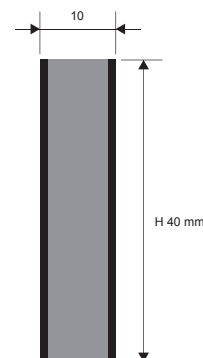

movement joints

EXAMPLES AND INSTRUCTIONS FOR LAYING METHODS

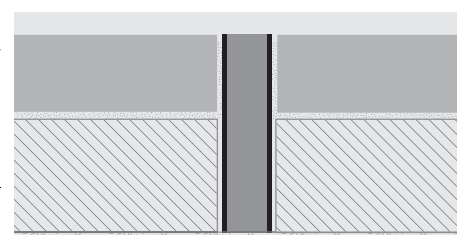

1. Choose the colour and the necessary height of the joint, calculating the thickness of the finished floor and the thickness of the screed. 2. Insert the joint into the screed letting it protrude slightly. 3. Proceed with laying the floor, aligning it with the rigid vertical part of the joint. 4. Complete laying by levelling the joint with the floor. 5. Using the mortar, grout the gap between the tiles and the profile.

MORTAR-LAID DOUBLE JOINT

VINYL RESIN CO-EXTRUSION (PVC) WITH DOUBLE SILICONE

THIS DOUBLE SILICONE JOINT is a co-extruded profile in hard and soft PVC. The double internal silicone provides a high degree of resistance to any type of compressive stress, heavy loads and foot traffic. The extension is designed to lengthen the joint, extending it to the total depth of auxiliary or insulation castings as required.



VINYL RESIN CO-EXTRUSION (PVC) WITH DOUBLE SILICONE
bar length 2,5 LM - pack. 40 Pcs - 100 LM (GDSP 43 - pack. 50 LM)

Article	L x H mm	€/LM	€/Pc
GDSP 43...	10 x 43	3,22	8,05
GDS 23...	10 x 23	1,79	4,48
GP 20	8 x 20	1,16	2,90

ARTICLES NOT FOR SALE SINGLY

Available combinations: GS - GT - GL. The code of the selected colour must be added to the article code. E.g.: GDSP 43... (combination chosen colour Dark Grey/Transparent) GDSP 43GT.

EXAMPLES AND INSTRUCTIONS FOR LAYING METHODS

1. Choose the colour and the necessary height of the joint, calculating the thickness of the finished floor and the thickness of the screed. 2. Insert the joint into the screed letting it protrude slightly. 3. Proceed with laying the floor, aligning it with the rigid vertical part of the joint. 4. Complete laying by levelling the joint with the floor. 5. Using the mortar, grout the gap between the tiles and the profile.



COLOURS

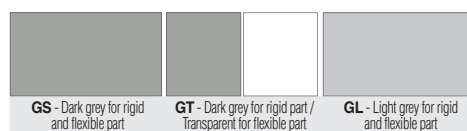

(for a precise assessment of colours and finishes, see the relative enclosed sheet)

GDSP 43...
scale 1:1

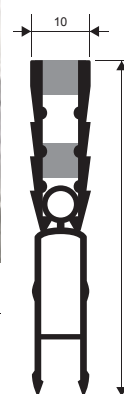

GDS 23...
scale 1:1

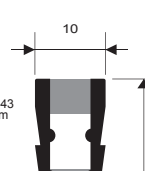

GP 20
scale 1:1

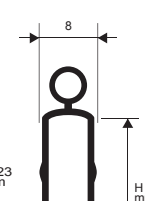

movement joints

EXAMPLES OF LAYING

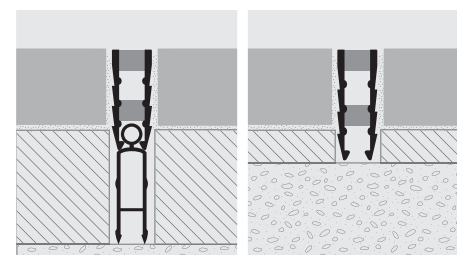

MORTAR LAYING FULL JOINT

CO-EXTRUDED VINYL RESIN (PVC)
WITH FULL SILICONE

FULL SILICONE JOINT is a co-extruded profile in hard and soft PVC. The double internal silicone provides a high degree of resistance to any type of compressive stress, heavy loads and foot traffic. The extension is designed to lengthen the joint, extending it to the total depth of auxiliary or insulation castings as required.

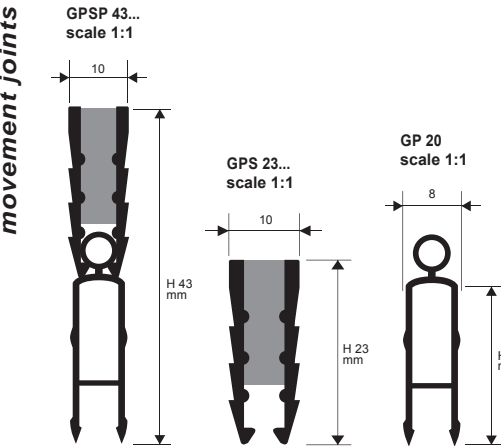

VINYL RESIN CO - EXTRUSION (PVC) with FULL SILICONE
bar length 2,5 LM - pack. 40 Pcs - 100 LM

Article	L x H mm	€/LM	€/Pc
GPSP 43...	10 x 43	4,31	10,78
GPS 23...	10 x 23	2,57	6,43
GP 20	8 x 20	1,16	2,90

COLOURS

GS - Dark grey for rigid and flexible part	GT - Dark grey for rigid part / Transparent for flexible part	GL - Light grey for rigid and flexible part

(for a precise assessment of colours and finishes, see the relative enclosed sheet)

EXAMPLES AND INSTRUCTIONS FOR LAYING METHODS

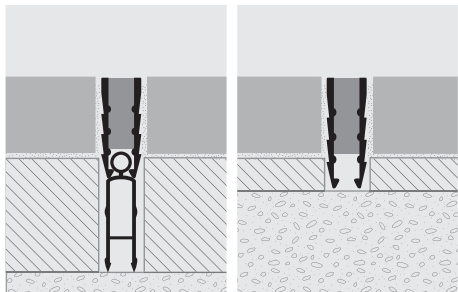

1. Choose the colour and the necessary height of the joint, calculating the thickness of the finished floor and the thickness of the screed. 2. Insert the joint into the screed letting it protrude slightly. 3. Proceed with laying the floor, aligning it with the rigid vertical part of the joint. 4. Complete laying by levelling the joint with the floor. 5. Using the mortar, grout the gap between the tiles and the profile.

ARTICLES NOT FOR SALE SINGLY

Available combinations: GS - GT - GL. The code of the selected colour must be added to the article code. E.g.: GPSP 43... (combination chosen colour Dark Grey/Transparent) GPSP 43GT.



PROEXPAN 115-130-190-210 is a range of structural expansion joints in natural aluminium with knurled flat surface and a black or grey synthetic rubber insert.

Made to withstand vertical, horizontal and transversal structural movements due to compressive and tensile stress in large buildings or complexes. The joint is laid on existing surfaces, also vertically, over the void between the two semi-detached surfaces of the same building or between two bays. It withstands frequent pedestrian traffic and also vehicles with rubber tyres that can load to 700 kgs. (PENF 190-210)

PROEXPAN 115-130-190-210

NATURAL ALUMINIUM
+ VINYL RESIN / RUBBER INSERT



NATURAL ALUMINIUM + VINYL RESIN / RUBBER INSERT
bar length 3 LM - pack. 10 Pcs - 30 LM

Article	LxHxLa mm	€/LM	€/Pc
PENF 115...	21 x 12 x 115	30,02	90,06
PENF 130...	38 x 12 x 128	32,66	97,98

NATURAL ALUMINIUM + NEOPRENE INSERT

bar length 3 LM - pack. 10 Pcs - 30 LM (L 90 mm - 4 LM while stocks last)

Article	LxHxLa mm	€/LM	€/Pc
PENF 190N (black)	65 x 19 x 185	67,27	269,08
PENF 210... (black or grey)	90 x 19 x 210	108,35	433,40

Movement mm: -10/+16 (PENF 190N) -15/+10 (PENF 210...). FOR 2 LM BAR CUT + 15%.

Available in the colours: G - N (PENF 190N excluded). The code of the selected colour must be added to the article code. E.g.: IPEN 20...

(chosen insert colour Grey) IPEN 20G.



INTERCHANGEABLE INSERT in VINYL RESIN/RUBBER INSERT
BLACK or GREY - bar length 3 LM - pack. 10 Pcs - 30 LM

Article	L mm	€/LM	€/Pc
IPEN 20...	20	5,51	16,53
IPEN 40...	35	7,97	23,91

INTERCHANGEABLE NEOPRENE INSERT BLACK or GREY

bar length 4 LM - pack. 10 Pcs - 40 LM

Article	L mm	€/LM	€/Pc
IPEN 65N (black)	65	15,41	61,64
IPEN 452... (black or grey)	45 x 2 Pz	23,62	94,48

Insert available in the colours: G - N (IPEN 65N excluded). The code of the selected colour must be added to the article code. E.g.: IPEN 20...

(chosen insert colour Grey) IPEN 20G.

PENF 115...
scale 1:2

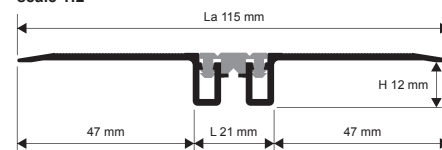

PENF 130...
scale 1:2

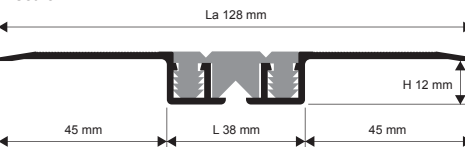

EXAMPLES AND INSTRUCTIONS FOR LAYING METHODS

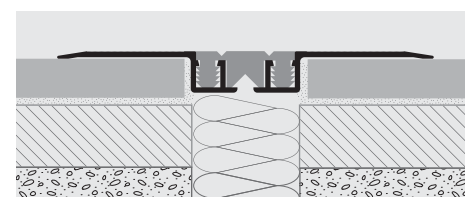

Fix the side wings/flanges in aluminium with.

1. Screws and screw anchors at 20cm intervals along both sides of the whole joint
2. Two-pack epoxy adhesive or with strong fast-setting silicone.

PRODUCT SUPPLIED NOT ASSEMBLED

COLOURS

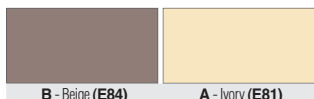
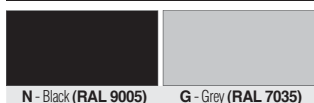

UPON REQUEST-MINIMUM
QUANTITY 100 LM - ONLY
FOR: PENF 115, PENF 130
(price and delivery time to
be agreed)

(for a precise assessment of colours and finishes,
see the relative enclosed sheet)

ANGLES BAR / WALL

NATURAL ALUMINIUM + NEOPRENE INSERT

ANGLE BAR NATURAL ALUMINIUM + NEOPRENE INSERT

bar length 3 LM - pack. 10 Pcs - 30 LM (L 90 mm - 4 ML while stocks last)

Article	LxHxLa mm	€/LM	€/Pc
PENFP 190N (black)	65 x 19 x 125	67,27	269,08
PENFP 210... (black or grey)	90 x 19 x 150	108,35	433,40

INTERCHANGEABLE INSERT in VINYL RESIN/RUBBER INSERT
BLACK or GREY - bar length 4 LM - pack. 10 Pcs - 40 LM

Article	L mm	€/LM	€/Pc
IPEN 65N (black)	65	15,41	61,64
IPEN 452... (black or grey)	45 x 2 PZ	23,62	94,48

FOR 2 LM BAR CUT + 15%.

Available in the colours: G - N. The code of the selected colour must be added to the article code. E.g.: PENFP 210... (chosen insert colour Grey) PENFP 210G.

PRODUCT SUPPLIED NOT ASSEMBLED

PENFP 190N
scale 1:2

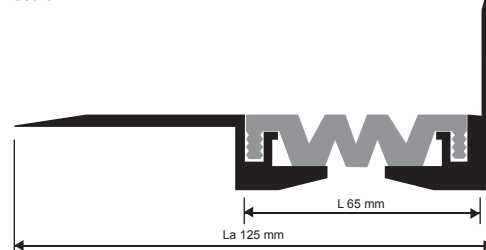

PENFP 210...
scale 1:2

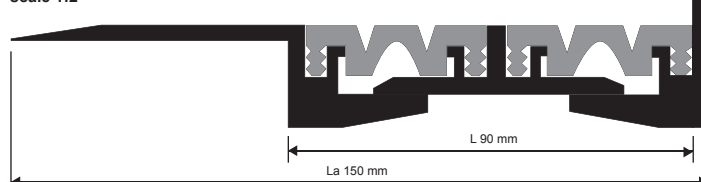

PROEXPAN H20 - H40

NATURAL ALUMINIUM
+ VINYL RESIN / RUBBER INSERT

structural joints

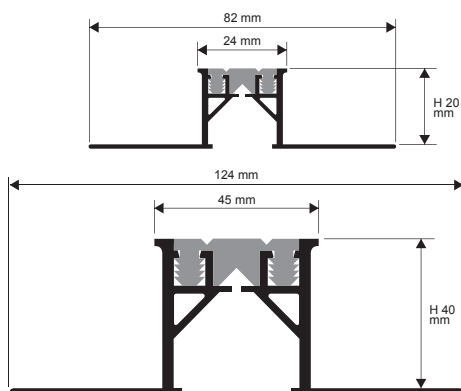

EXAMPLES AND INSTRUCTIONS FOR LAYING METHODS

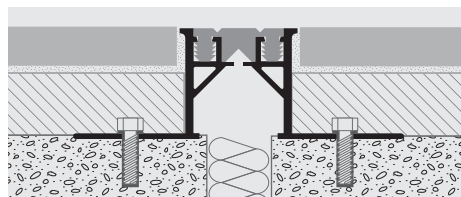

1. Choose the expansion joint with suitable height for the thickness of the floor and the screed/floor rough and choose the colour of the insert. 2. Fix the punched flanges to the substrate using screws and screw anchors, calculating the fixing points at 30cm intervals on both sides. 3. Make the screed over the punched flanges of the structural or expansion joint, calculating the thickness of the final floor, and then lay the floor as normal.

PROEXPAN is a range of professional structural joints for floors laid on mortar bed (PEN H20) and (PEN H 40). They are made with a punched aluminium base and a vinyl rubber insert available in black or grey. **PROEXPAN** profiles for laying with mortar must have the flanges fixed to the substrate by screws and screw anchors (approx. every 30 cm).



INSERT COLOURS

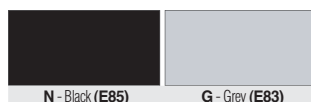

(price and delivery time to be agreed)

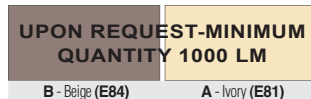

(for a precise assessment of colours and finishes, see the relative enclosed sheet)



NATURAL ALUMINIUM + VINYL RESIN / RUBBER INSERT
bar length 3 LM - pack. 5 Pcs - 15 LM

Article	HxL mm	€/LM	€/Pc
PEN 20...	20 x 24	43,54	130,62
PEN 40...	40 x 45	58,22	174,66

ANGLE BAR / WALL NATURAL ALUMINIUM + VINYL RESIN / RUBBER INSERT - bar length 3 LM - pack. 5 Pcs - 15 LM

Article	HxLmm	€/LM	€/Pc
PENP 20...	20 x 24	43,54	130,62
PENP 40...	40 x 45	58,22	174,66

Available in the colours: G - N (Beige and Ivory available upon request with a minimum quantity order of 100 LM). The code of the selected colour must be added to the article code.
E.g.: PEN 20... (chosen insert colour Grey) PEN 20G.

GDA 25 - GDA 35

NATURAL ALUMINIUM
+ NEOPRENE INSERT

structural joints

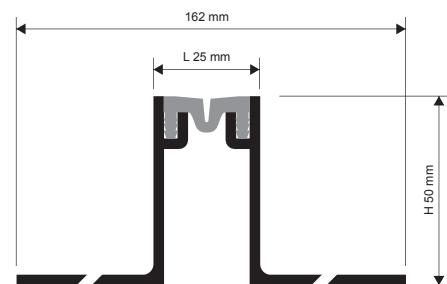

INSERT COLOURS

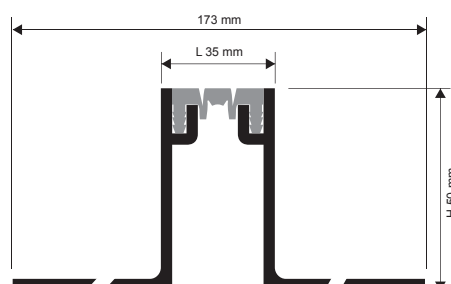
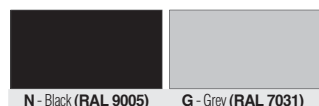

AVAILABLE

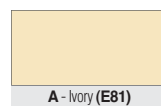

UPON REQUEST-MINIMUM QUANTITY 400 LM - GDA 25/ GDAP 25 (PRICE AND DELIVERY TIME TO BE AGREED)
UPON REQUEST-MINIMUM QUANTITY 300 LM - GDA 35/ GDAP 35 (PRICE AND DELIVERY TIME TO BE AGREED)



NATURAL ALUMINIUM + NEOPRENE INSERT
bar length 3 LM

Article	HxL mm	€/LM	€/Pc
GDA 25...	50 x 25	49,30	147,90
GDA 35...	50 x 35	55,46	166,38

Movement mm: +/- 5
FOR 2 LM BAR CUT + 15%.

ANGLE BAR / WALL NATURAL ALUMINIUM + NEOPRENE INSERT - bar length 3 LM

Article	HxL mm	€/LM	€/Pc
GDAP 25...	50 x 25	49,30	147,90
GDAP 35...	50 x 35	55,46	166,38

FOR 2 LM BAR CUT + 15%.
Available in the colours: G - N (Ivory available upon request with a minimum). The code of the selected colour must be added to the article code.
E.g.: GDA 25... (chosen insert colour Grey) GDA 25G.

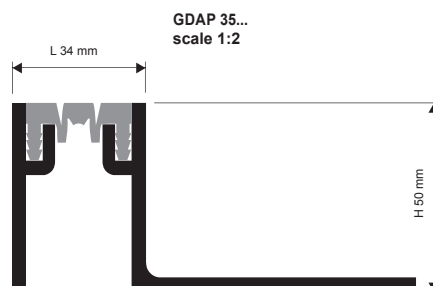
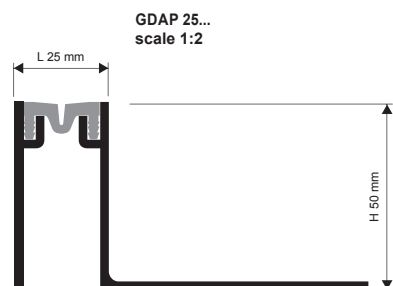

STRUCTURAL JOINT for floors, 35, 50 and 80 mm, in good quality natural aluminium with the interchangeable neoprene insert allowing the joint to expand and contract. Visible thickness 55 mm (**GDA 55**), bar length 4 m. Black or Grey insert. Bear weights of cars, with the wheel loads up to 650 kg and trucks with a maximum load of 1000 kg on the wheel

GDA 55

ALUMINIUM
+ NEOPRENE INSERT



ALUMINIUM + NEOPRENE INSERT BLACK / GREY bar length 3 LM

Article	L x H x L1 mm	€/LM	€/Pc
GDA 5535...	55 x 35 x 155	61,11	183,33
GDA 5550...	55 x 50 x 155	70,35	211,05
GDA 5580...	55 x 80 x 155	99,11	297,33

Movement mm: +/- 10

FOR 2 LM BAR CUT + 15%.

ON DEMAND WITH FLAT INSERT +15%

Available in the colours: G - N. The code of the selected colour must be added to the article code.

E.g.: GDA 5535... (chosen insert colour Black) GDA 5535N

ANGLES BAR ALUMINIUM + NEOPRENE INSERT BLACK bar length 3 LM

Article	L x H x L1 mm	€/LM	€/Pc
GDAP 5535	55 x 35 X 105	61,11	183,33
GDAP 5550	55 x 50 X 105	70,35	211,05
GDAP 5580	55 x 80 X 105	99,11	297,33

FOR 2 LM BAR CUT + 15%.

ON DEMAND WITH FLAT INSERT +15%

COLOURS



(for a precise assessment of colours and finishes, see the relative enclosed sheet)

EXAMPLES AND INSTRUCTIONS FOR LAYING METHODS

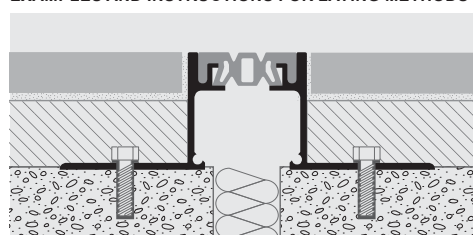

1. Choose the expansion joint with suitable height for the thickness of the floor and the screed/floor rough and choose the colour of the insert. 2. Fix the punched flanges to the substrate using screws and screw anchors, calculating the fixing points at 30cm intervals on both sides. 3. Make the screed over the punched flanges of the structural or expansion joint, calculating the thickness of the final floor, and then lay the floor as normal.

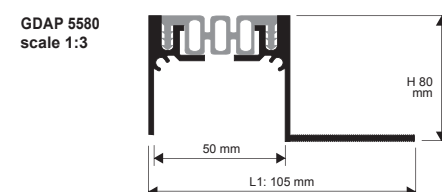
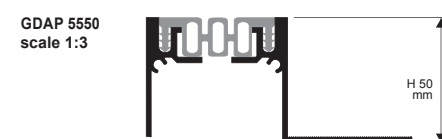
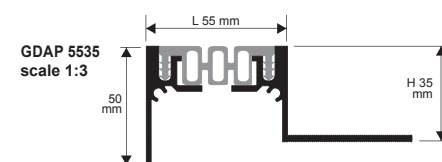
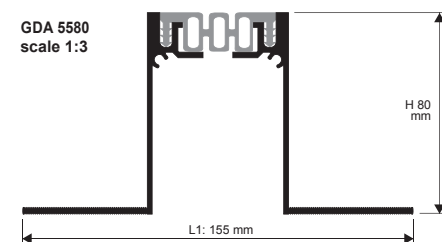
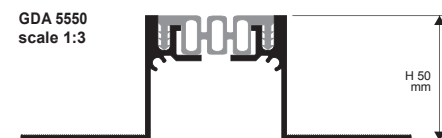
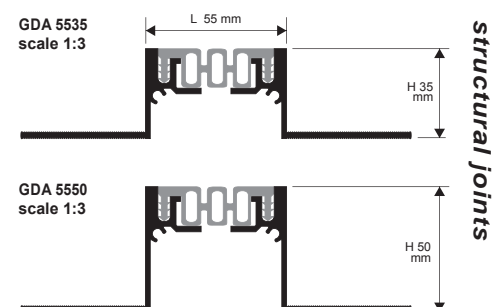

structural joints

movement and
expansion joints

FIREPROOF CORD

MINERAL WOOL AND FIBREGLASS

FIREPROOF GLUE for CORD FIXING

Article	pack. Kg	€/Kg	€/pack.
CIC 014	1,4	39,54	55,36
CIC 7	7	21,16	148,12

The delivery of the test certificate depends on the use of silicate glue for the fixing of the same.

The cord is certified in accordance with the new European Standard EN 13501-2.

Consumption of sealant is of about 50 g per linear metre of cord.

FIREPROOF CORD - Diameter 20 - 60 mm

Article	Ø mm	ML Roll	€/LM	€/Roll
CDT 20	20	30	8,73	261,90
CDT 30	30	30	9,24	277,20
CDT 40	40	30	13,35	400,50
CDT 50	50	25	14,38	359,50
CDT 60	60	25	16,95	423,75



* = Upon request, delivery time to be agreed.

Prices are referred to whole packs. 10% increase for minimum orders of 10 pcs. 20% increase for orders of less than 10 pcs.

GNS 20 - GNS 50

NATURAL ALUMINIUM

STRUCTURAL JOINT **GNS 20/50** is in good quality natural aluminium with neoprene in the lower central part and another aluminium profile in the upper visible part. It withstands heavy loads and frequent traffic of vehicles with a total truckload of 8 kgs/mm². Bar length 3 m, visible head width 30 mm.

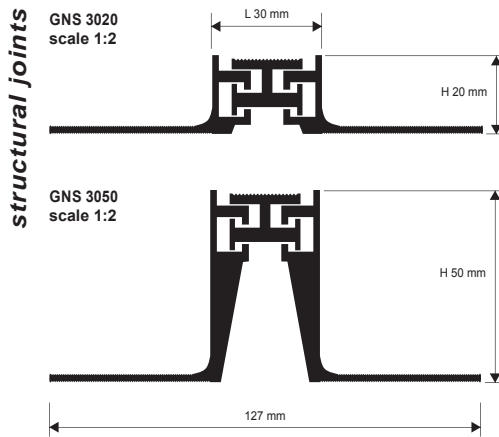

NATURAL ALUMINIUM
bar length 3 LM

Article	L x H mm	€/LM	€/Pc
GNS 3020	30 x 20	60,59	181,77
GNS 3050	30 x 50	71,89	215,67

Movement mm: +/- 3
FOR 2 LM BAR CUT + 15%.

EXAMPLES AND INSTRUCTIONS FOR LAYING METHODS

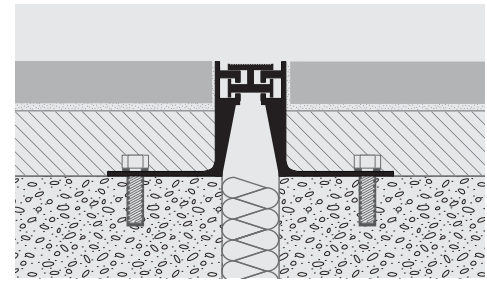

1. Choose the expansion joint with suitable height for the thickness of the floor and the screed/floor rough and choose the colour of the insert. 2. Fix the punched flanges to the substrate using screws and screw anchors, calculating the fixing points at 30cm intervals on both sides. 3. Make the screed over the punched flanges of the structural or expansion joint, calculating the thickness of the final floor, and then lay the floor as normal.

ANGLES BAR / WALL

NATURAL ALUMINIUM

GNSP 3050

GNSP 3020

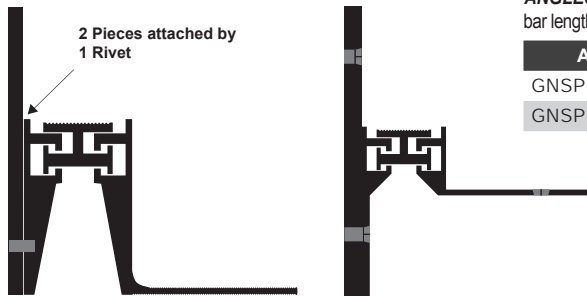

ANGLES BAR NATURAL ALUMINIUM
bar length 3 LM - pack. 10 Pcs - 30 LM

Article	L x H mm	€/LM	€/Pc
GNSP 3020	30 x 20	60,59	181,77
GNSP 3050	30 x 50	71,89	215,67

COLOURS



(for a precise assessment of colours and finishes, see the relative enclosed sheet)

GNS 75...18/50/80

NATURAL ALUMINIUM

STRUCTURAL JOINT **GNS 75...18/50/80** is in good quality natural aluminium with neoprene in the lower central part and another aluminium profile in the upper visible part. It withstands heavy loads and frequent pedestrian traffic. Bar length 4 m, visible head width 75 mm. It withstands forklift trucks with rubber tyre and transpallets to a maximum total load of 6,5 kgs/mm².

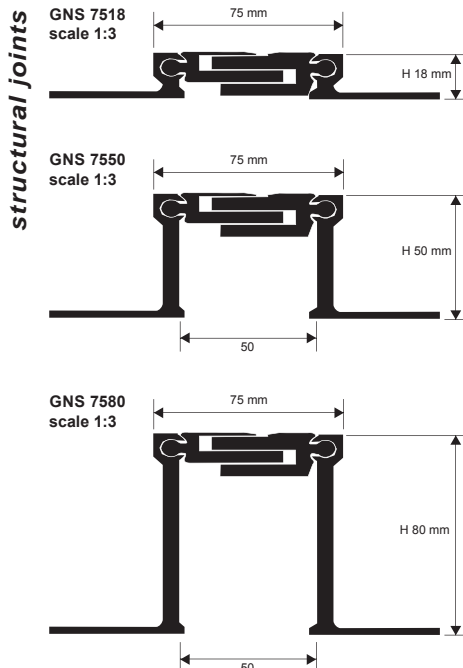

NATURAL ALUMINIUM
bar length 3 LM

Article	H mm	€/LM	€/Pc
GNS 7518	18	108,35	325,05
GNS 7550	50	129,40	388,20
GNS 7580	80	143,78	431,34

Movement mm: +10/-5 Horiz. +/-5 Vert.
FOR 2 LM BAR CUT + 15%.

EXAMPLES AND INSTRUCTIONS FOR LAYING METHODS

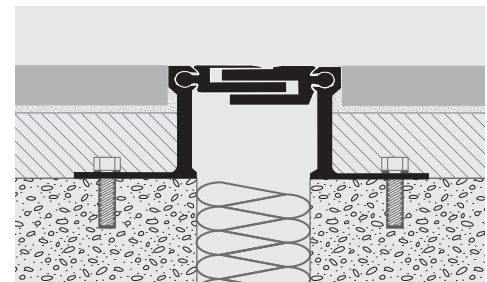

1. Choose the expansion joint with suitable height for the thickness of the floor and the screed/floor rough and choose the colour of the insert. 2. Fix the punched flanges to the substrate using screws and screw anchors, calculating the fixing points at 30cm intervals on both sides. 3. Make the screed over the punched flanges of the structural or expansion joint, calculating the thickness of the final floor, and then lay the floor as normal.

COLOURS



(for a precise assessment of colours and finishes, see the relative enclosed sheet)

PROPLATE FIX is a range of flat joint-cover profiles to cover structural movements (contraction due to flexural or compressive stress) of two different load-bearing structures.

PROPLATE FIX made in silver anodised aluminium is recommended for environments with intense pedestrian and vehicular traffic. Available upon request with stainless steel fixing clips (5 pcs. for vertical/façade use 10 pcs. for horizontal/floor use); corner profiles are also available.



FLAT PROFILE - SILVER ANOD. ALUMINIUM
bar length 3 LM - pack. 20 Pcs - 60 LM

Article	L mm	€/LM	€/Pc
PETFXPAA 50	50	13,97	41,91
PETFXPAA 70	70	24,24	72,72



ANGLE PROFILE - SILVER ANOD. ALUMINIUM
bar length 3 LM - pack. 20 Pcs - 60 LM

Article	H x L mm	€/LM	€/Pc
PETFXAA 50	22 x 50	14,60	43,80
PETFXAA 70	24 x 70	21,72	65,16

PRODUCT SUPPLIED NOT ASSEMBLED

FIXING CLIPS between 20 and 45 mm - STAINLESS STEEL - pack. 10 Pcs

Article	H mm	€/Pc	€/pack.
CPFXAC 40	40	1,85	18,50

EXAMPLES AND INSTRUCTIONS FOR LAYING METHODS

1. Choose the profile in the required width and material. 2. Insert the fixing clips into the relative groove, one every 50/75 cm (5 pcs. for wall applications - 10 pcs. for floor applications). 3. Insert/Lay the PROPLATE FIX in the existing void, applying uniform pressure or using a plastic hammer, thereby creating a perfect joint cover. The same method is used for laying the corner profile.

COLOURS



(for a precise assessment of colours and finishes, see the relative enclosed sheet)

PROPLATE FIX

FLAT AND ANGLE PROFILE IN ALUMINIUM

PETFXPAA 50
scale 1:2

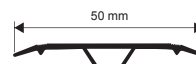

PETFXPAA 70
scale 1:2

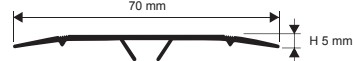

PETFXAA 50
scale 1:2

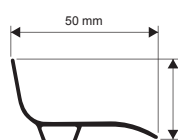

PETFXAA 70
scale 1:2

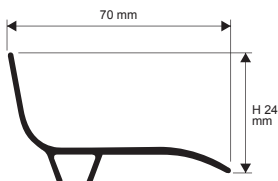

EXAMPLES OF LAYING

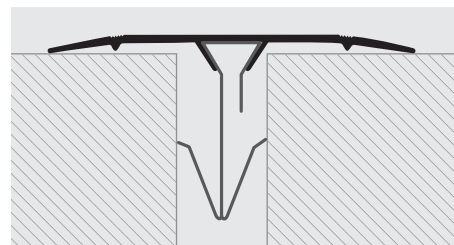

PROPLATE FIX is a range of flat joint-cover profiles to cover structural movements (contraction due to flexural or compressive stress) of two different load-bearing structures.

PROPLATE FIX made in rigid PVC is recommended for walls and facades and for ceilings. Available upon request with stainless steel fixing clips (5 pcs. for vertical/façade use 10 pcs. for horizontal/floor use); corner profiles are also available.

PROPLATE FIX

FLAT AND ANGLE PROFILE IN VINYL RESIN (PVC)



FLAT PROFILE - VINYL RESIN (PVC)
bar length 3 LM - pack. 20 Pcs - 60 LM

Article	L mm	€/LM	€/Pc
PETFXP 50-01	50	9,29	27,87



ANGLE PROFILE - VINYL RESIN (PVC)
bar length 3 LM - pack. 20 Pcs - 60 LM

Article	H x L mm	€/LM	€/Pc
PETFX 50-01	22 x 50	9,60	28,80

PETFXP 50-01
scale 1:2



PETFX 50-01
scale 1:2

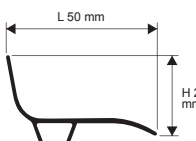

EXAMPLES AND INSTRUCTIONS FOR LAYING METHODS

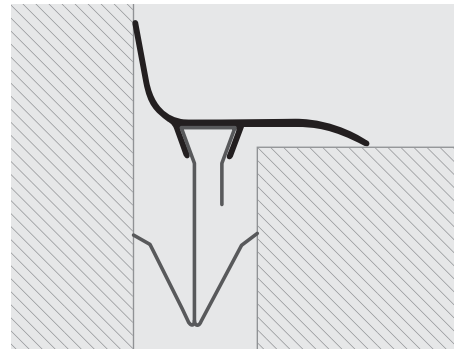

1. Choose the profile in the required width and material. 2. Insert the fixing clips into the relative groove (5 pcs. for wall applications - 10 pcs. for floor applications). 3. Insert/Lay the PROPLATE FIX in the existing void, applying uniform pressure or using a plastic hammer, thereby creating a perfect joint cover. The same method is used for laying the corner profile.

COLOURS



(for a precise assessment of colours and finishes, see the relative enclosed sheet)

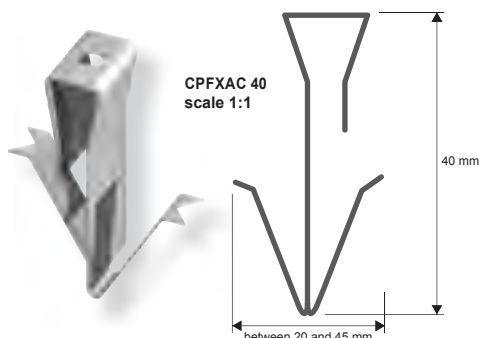



PROFILES & SYSTEMS



- profiles, membranes for terraces/
balconies & drainage systems

PROTERRACE DRAIN FDP

VARNISHED/COATED ALUMINIUM

PROTERRACE DRAIN FDP is an edging profile in colored aluminium, designed to protect the edges of tiles on terraces and balconies and to allow the downflow of water. The profile is provided with a perforated anchoring flange that ensures perfect fastening of the profile to the substrate and a vertical side, protecting the edge of the flooring, partly bended outwards in order to allow the downflow of water. Moreover, the profile has perimetral holes for the outflow of water that may seep from under the tiles.

PROTERRACE DRAIN FDP is available in 5 different colors; it is equipped with special completing elements, such as pre-welded outside corners and linking elements, that facilitate its installation.

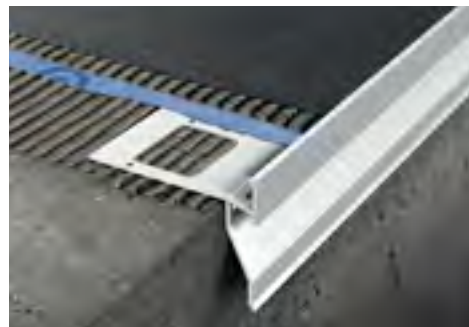
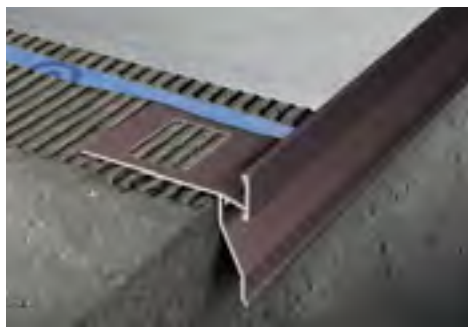
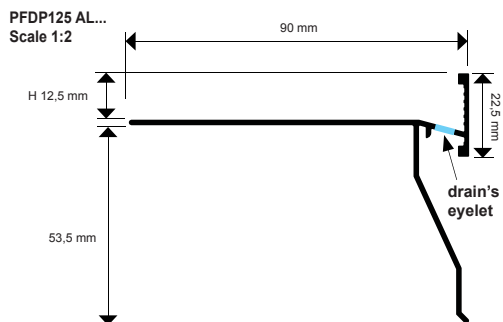
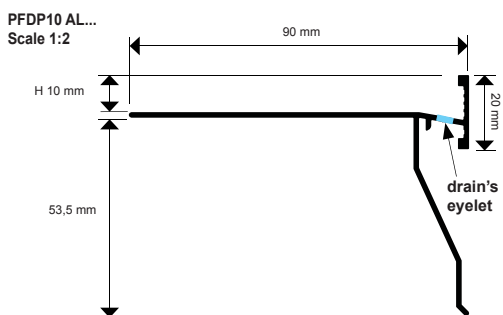

VARNISHED/COATED ALUMINIUM

bar length 2,7 ML - Pack 5 Pcs - 13,5 ML

Article	H mm	€/ML	€/Pc
PFDP 10AL...	10	25,50	68,85
PFDP 125AL...	12,5	25,90	69,93

Available in the colours: B-G-T-E-A-CORTEN. The code of the selected colour must be added to the article code.
E.g.: PFDP 10AL... (White)
PFDP 10ALB

COLOURS

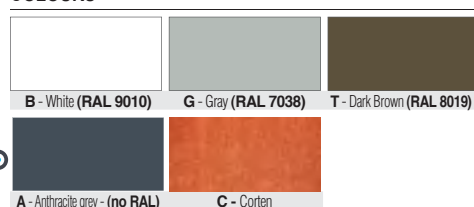

AVAILABLE



OUTSIDE CORNER - Pack 10 Pcs

Article	€/Pc	€/Pack
AEPFDP 10AL...	32,20	322,00
AEPFDP 125AL...	32,50	325,00

JOINTS - Pack 10 Pcs (upper / lower)

Article	€/Pc	€/Pack
GINFDP 10AL .../1	5,90	59,00
GINFDP 125AL .../1	5,90	59,00

The junction is composed of one upper pieces (GINFDP 10AL .../1) and one lower piece (GINFDP AL ...).



EXAMPLES AND INSTRUCTIONS FOR LAYING METHODS

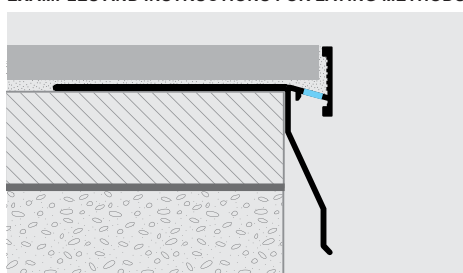

1. Choose the PROTERRACE DRAIN FDP in accordance to the thickness of the tile and of the desired finishing; 2. Fix the pre-welded outside corners to the screed; 3. Cut the PROTERRACE DRAIN FDP at desired length; lay the profile, joining it to the corners using the linking element and fastening it with screws to the substrate; 4. Apply the desired waterproofing system, sealing the profile to the joint; 5. Lay the tiles, leaving at least about 5 millimeters between the tile and the profile; 6. Fill the space between the tiles and the profile with a plaster suitable for the chosen floor covering.

DRAIN EYELET

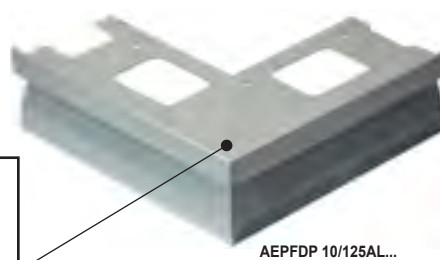
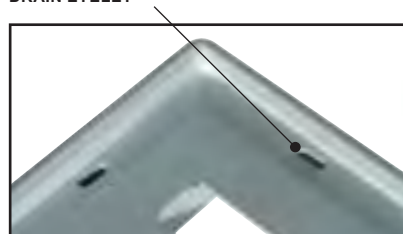

News 2015



© 2011 All rights reserved by Progress Profiles. Printed in Italy

PROTERRACE PCG in stainless steel AISI 304/1.4301-V2A is a range of edging profiles for finishing and protecting the concrete front edges of terraces and balconies. The profile has been designed with a tile retaining and finishing detent 10 or 12.5 mm in height plus a drainage corner to protect the screed. Placing it under the waterproofing membrane, it acts as a drip moulding. It can be laid flush with or detached from the screed according to whether the tiles are laid flush with or protruding from the screed. Available in 3 with standard punched base (width 80 mm) and heights 55, 75 and 95 mm, in the versions with detent 10 or 12.5 mm. Prewelded outside and corner joints as well as corner linking elements also available to join the profile longitudinally.



POLISHED STAINLESS STEEL AISI 304/1.4301-V2A with protective film - bar length 2,7 LM - pack. 5 Pcs - 13,5 LM (H 55 mm - 18,9 LM)

Article	h x H x L mm	€/LM	€/Pc
PCG10 8055AC	10 x 55 x 80	27,68	74,74
PCG10 8075AC	10 x 75 x 80	30,71	82,92
PCG10 8095AC	10 x 95 x 80	34,40	92,88
PCG125 8055AC	12,5 x 55 x 80	27,93	75,41
PCG125 8075AC	12,5 x 75 x 80	31,02	83,75
PCG125 8095AC	12,5 x 95 x 80	34,51	93,18

EXAMPLES AND INSTRUCTIONS FOR LAYING METHODS

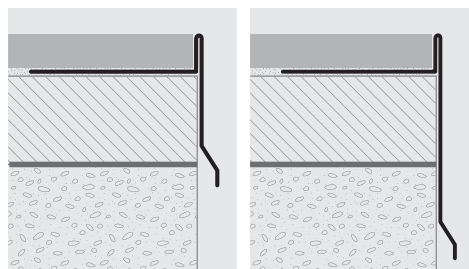

1. Choose the PROTERRACE PCG of the type and finish suitable for the thickness of the screed. 2. Lay the PROTERRACE PCG along the edge of the surface to be tiled at the same time as laying the tiles and using the same adhesive. 3. For a perfect waterproofing, below the glue it is recommended to use an elastic membrane product (e.g. Mapelastico - Rasoeleastic - Elastocem - Elastomalta - Idrobuilt) and our sheathing/waterproof membrane/drainage PROFILMAT and/or PRODRAIN.

PROTERRACE PCG

STAINLESS STEEL AISI 304/1.4301-V2A

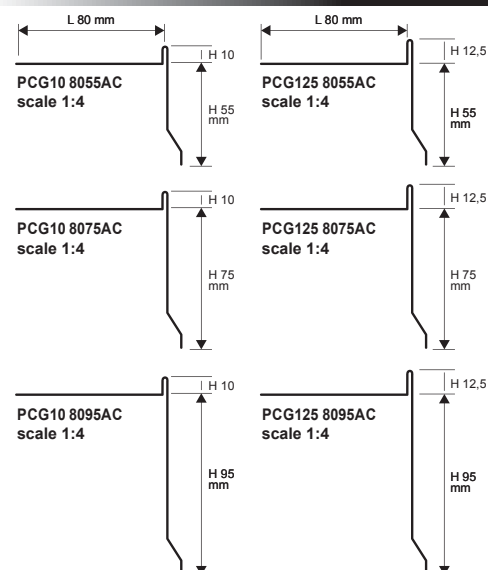

OUTSIDE CORNERS and JOINTS

POLISHED STAINLESS STEEL AISI 304/1.4301-V2A

OUTSIDE CORNERS - pack. 10 Pcs

Article	€/Pc	€/pack.
AEPG10 55AC/75AC/95AC	38,20	382,00
AEPG125 55AC/75AC/95AC	38,20	382,00

JOINTS - pack. 10 Pcs

Article	€/Pc	€/pack.
GING10 55AC/75AC/95AC	6,11	61,10
GING125 55AC/75AC/95AC	6,11	61,10

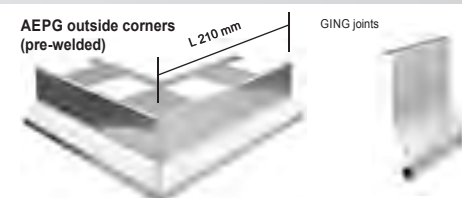

PROTERRACE PCG in varnished/coated aluminium is a range of edging profiles for finishing and protecting the concrete front edges of terraces and balconies. The profile has been designed with a tile retaining and finishing detent 10 or 12.5 mm in height plus a drainage corner to protect the screed. Placing it under the waterproofing membrane, it acts as a drip moulding. It can be laid flush with or detached from the screed according to whether the tiles are laid flush with or protruding from the screed. Available in 3 with standard punched base (width 80 mm) and heights 55, 75 and 95 mm, in the versions with detent 10 or 12.5 mm. Prewelded outside and corner joints as well as corner linking elements also available to join the profile longitudinally.



VARNISHED/COATED ALU. - bar length 2,7 LM pack. 5 Pcs - 13,5 LM (H 55mm - 18,9 LM)

Article	h x H x L mm	€/LM	€/Pc
PCG10 8055AL...	10 x 55 x 80	17,61	47,55
PCG10 8075AL...	10 x 75 x 80	20,03	54,08
PCG10 8095AL...	10 x 95 x 80	22,90	61,83
PCG125 8055AL...	12,5 x 55 x 80	17,61	47,55
PCG125 8075AL...	12,5 x 75 x 80	20,03	54,08
PCG125 8095AL...	12,5 x 95 x 80	22,90	61,83

Available in the colours: B-G-E-T-A-C-. The code of the selected colour must be added to the article code. E.g.: PCG10 8055AL... (colour White) PCG10 8055ALB.

EXAMPLES OF LAYING (for laying instructions, see above)

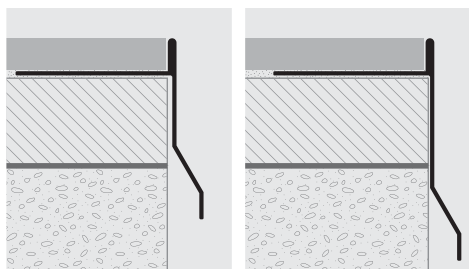

COLOURS

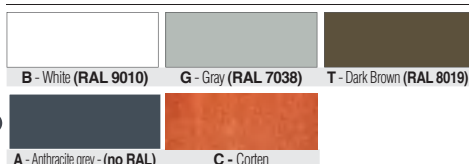

AVAILABLE



PROTERRACE PCG

VARNISHED/COATED ALUMINIUM

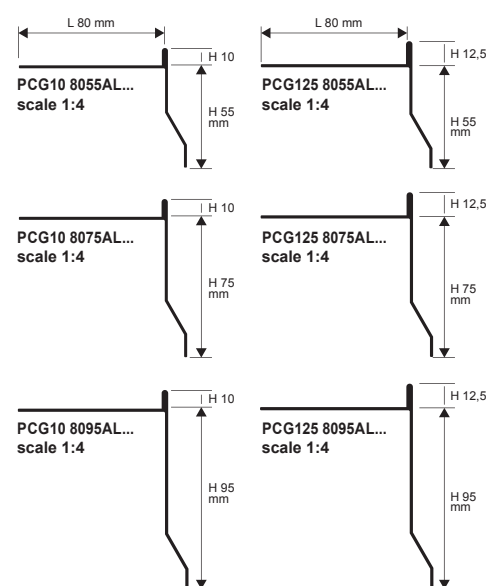

OUTSIDE CORNERS and JOINTS

VARNISHED/COATED ALUMINIUM

OUTSIDE CORNERS - pack. 10 Pcs

Article	€/Pc	€/pack.
AEPG10 55AL../75AL../95AL..	24,96	249,60
AEPG125 55AL../75AL../95AL..	24,96	249,60

Available in the colours: B-G-E-T-A-C-. The code of the selected colour must be added to the article code. E.g.: AEPG10 55AL... (colour White) AEPG10 55ALB.

JOINTS - pack. 10 Pcs

Article	€/Pc	€/pack.
GING10 55AL../75AL../95AL..	4,93	49,30
GING125 55AL../75AL../95AL..	4,93	49,30

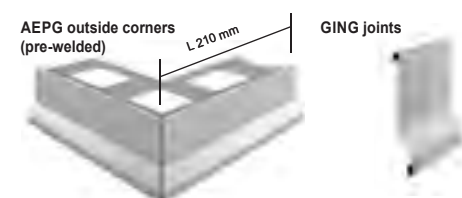

PROTERRACE PCJ

VARNISHED/COATED ALUMINIUM

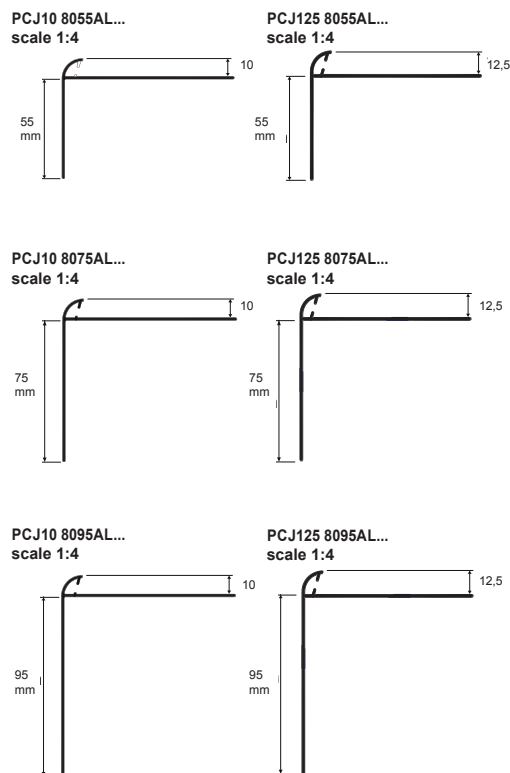

PROTERRACE PCJ in varnished/coated aluminium is a range of edging profiles for finishing and protecting the concrete front edges of terraces and balconies. The profile has been designed with a tile retaining and finishing joint 10 or 12.5 mm in height plus a drainage corner to protect the screed. Placing it under the waterproofing membrane, it acts as a drip moulding. It can be laid flush with or detached from the screed according to whether the tiles are laid flush with or protruding from the screed. Available in 3 with standard punched base (width 80 mm) and heights 55, 75 and 95 mm, in the versions with joint 10 or 12.5 mm. Prewelded outside and corner joints as well as corner linking elements also available to join the profile longitudinally.



VARNISHED/COATED ALUMINIUM
bar length 2,7 LM - pack. 7 Pcs - 18,9 LM (H 75 mm - 13,5 ML - H 95 mm - 5,4 LM)

Article	h x H x L mm	€/LM	€/Pc
PCJ10 8055AL...	10 x 55 x 80	17,66	47,68
PCJ10 8075AL...	10 x 75 x 80	19,98	53,95
PCJ10 8095AL...	10 x 95 x 80	22,80	61,56
PCJ125 8055AL...	12,5 x 55 x 80	17,77	47,98
PCJ125 8075AL...	12,5 x 75 x 80	20,08	54,22
PCJ125 8095AL...	12,5 x 95 x 80	22,90	61,83

Available in the colours: B-G-E-T-C-A. The code of the selected colour must be added to the article code. E.g.: PCJ10 8055AL... (colour White) PCJ10 8055ALB.

**PRODUCTIONS ON REQUEST:
DELIVERY TIME TO BE AGREED.**

EXAMPLES AND INSTRUCTIONS FOR LAYING METHODS

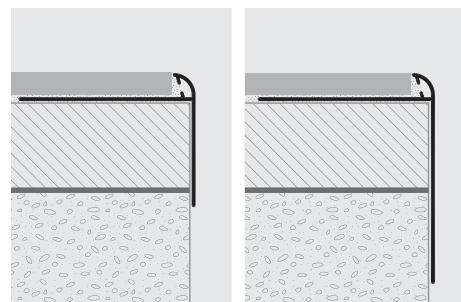

1. Choose the PROTERRACE PCJ of the type and finish suitable for the thickness of the screed. 2. Lay the PROTERRACE PCJ along the edge of the surface to be tiled at the same time as laying the tiles and using the same adhesive. 3. For a perfect waterproofing, below the glue it is recommended to use an elastic membrane product (e.g. Mapelastic - Rasoeleastic - Elastocem - Elastomalt - Idrobuilt) and our sheathing/waterproof membrane/drainage PROFILMAT and/or PRODRAIN.

COLOURS

B - White (RAL 9010)	G - Gray (RAL 7038)	A - Anthracite grey - (no RAL)
----------------------	---------------------	--------------------------------

AVAILABLE

C - Corten	E - Beige (RAL 1019)	T - Dark Brown (RAL 8019)
------------	----------------------	---------------------------

News 2015

OUTSIDE CORNERS and JOINTS

VARNISHED/COATED ALUMINIUM

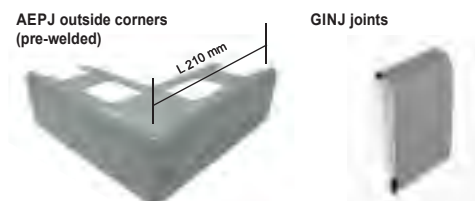

OUTSIDE CORNERS - pack. 10 Pcs

Article	€/Pc	€/pack.
AEPJ10 55AL../75AL../95AL..	25,16	251,60
AEPJ125 55AL../75AL../95AL..	25,16	251,60

Available in the colours: B-G-E-T-C-A. The code of the selected colour must be added to the article code. E.g.: AEPJ10 55AL... (colour White) AEPJ10 55ALB.

JOINTS - pack. 10 Pcs

Article	€/Pc	€/pack.
GINJ10 55AL../75AL../95AL..	4,93	49,30
GINJ125 55AL../75AL../95AL..	4,93	49,30

PROTERRACE ECO

ALUMINIUM

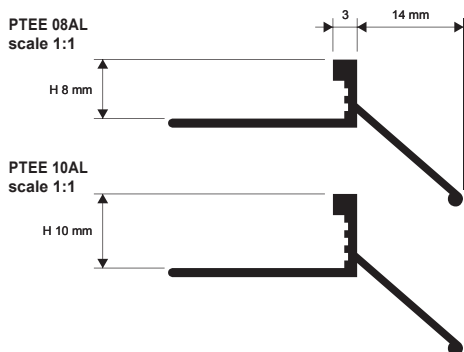

EXAMPLES AND INSTRUCTIONS FOR LAYING METHODS

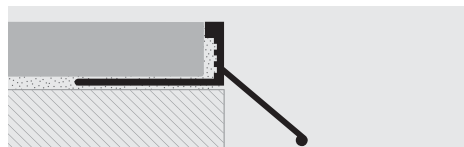

1. Choose the profile with the required height. 2. Lay the PROTERRACE-ECO along the edge of the surface to be tiled at the same time as laying the tiles and using the same adhesive. 3. For a perfect waterproofing, below the glue it is recommended to use an elastic membrane product (e.g. Mapelastic - Rasoeleastic - Elastocem - Elastomalt - Idrobuilt) and our sheathing/waterproof membrane/drainage PROFILMAT and/or PRODRAIN.

NATURAL ALUMINIUM - 5 pack. thermo packed

bar length 2,7 LM - pack. 20 Pcs - 54 LM

Article	H mm	€/LM	€/Pc
PTEE 08AN	8	4,86	13,12
PTEE 10AN	10	5,34	14,42

NATURAL ALUMINIUM thermo packed

bar length 2,7 LM - pack. 20 Pcs - 54 LM

Article	H mm	€/LM	€/Pc
PTEE 08AA	8	5,90	15,93
PTEE 10AA	10	6,40	17,28

ARTICLES NOT FOR SALE SINGLY

COLOURS

AN - Natural aluminium	AA - Silver anod. alu.
------------------------	------------------------

(for a precise assessment of colours and finishes, see the relative enclosed sheet)

PROTERRACE PC in stainless steel AISI 304/1.4301-V2A is a range of edging profiles for finishing and protecting the concrete front edges of terraces and balconies. The profile has been designed with a drainage corner to protect the screed. Placing it under the waterproofing membrane, it acts as a drip moulding. It can be laid flush with or detached from the screed according to whether the tiles are laid flush with or protruding from the screed. Available in 3 with standard punched base (width 80 mm) and heights 55, 75 and 95 mm. Prewelded outside and corner joints as well as corner linking elements also available to join the profile longitudinally.

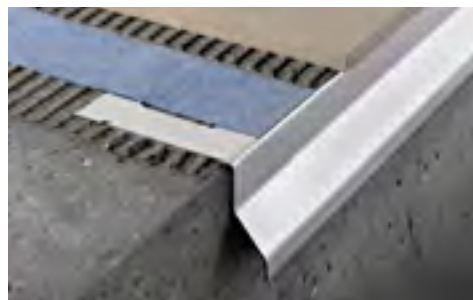

POLISHED STAINLESS STEEL AISI 304/1.4301-V2A with protective film - bar length 2,7 LM - pack. 7 Pcs - 18,9 LM (H 75 mm - 13,5 LM - H 95 mm - 5,4 LM)

Article	L x H mm	€/LM	€/Pc
PC 8055AC	80 x 55	26,15	70,61
PC 8075AC	80 x 75	29,06	78,46
PC 8095AC	80 x 95	32,30	87,21

EXAMPLES AND INSTRUCTIONS FOR LAYING METHODS

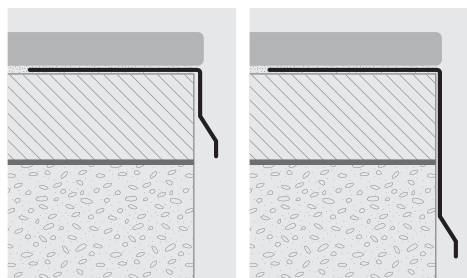

1. Choose the PROTERRACE PC of the type and finish suitable for the thickness of the screed. 2. Lay the PROTERRACE PC along the edge of the surface to be tiled at the same time as laying the tiles and using the same adhesive. 3. For a perfect waterproofing, below the glue it is recommended to use an elastic membrane product (e.g. Mapelastoc - Rasoeastic - Elastocem - Elastomalta - Idrobuilt) and our sheathing/waterproof membrane/drainage PROFILMAT and/or PRODRAIN

PROTERRACE PC

STAINLESS STEEL AISI 304/1.4301-V2A

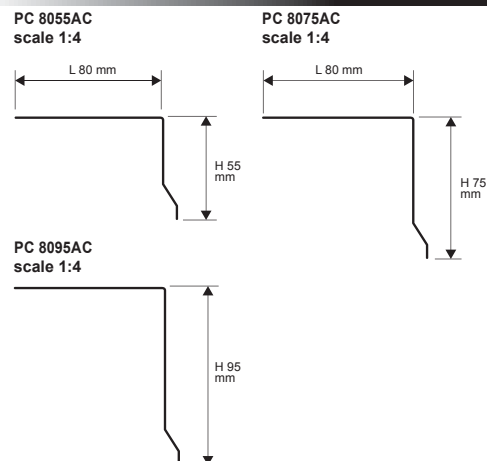

OUTSIDE CORNERS and JOINTS

POLISHED STAINLESS STEEL AISI 304/1.4301-V2A

OUTSIDE CORNERS - pack. 10 Pcs

Article	€/Pc	€/pack.
AEPC 55AC	38,07	380,70
AEPC 75AC	38,07	380,70
AEPC 95AC	38,07	380,70

JOINTS - pack. 10 Pcs

Article	€/Pc	€/pack.
GINC 55AC	6,11	61,10
GINC 75AC	6,11	61,10
GINC 95AC	6,11	61,10

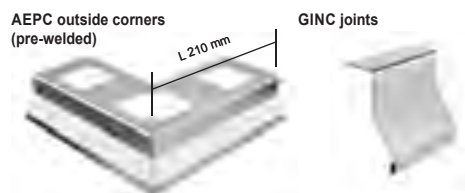

PROTERRACE PC varnished/coated aluminium is a range of edging profiles for finishing and protecting the concrete front edges of terraces and balconies. The profile has been designed with a drainage corner to protect the screed. Placing it under the waterproofing membrane, it acts as a drip moulding. It can be laid flush with or detached from the screed according to whether the tiles are laid flush with or protruding from the screed. Available in 3 with standard punched base (width 80 mm) and heights 55, 75 and 95 mm. Prewelded outside and corner joints as well as corner linking elements also available to join the profile longitudinally.



VARNISHED/COATED ALUMINIUM - bar length 2,7 LM
pack. 7 Pcs - 18,9 LM (H 75 mm - 13,5 LM H 95 mm - 5,4 LM)

Article	L x H mm	€/LM	€/Pc
PC 8055AL...	80 x 55	16,48	44,50
PC 8075AL...	80 x 75	18,69	50,46
PC 8095AL...	80 x 95	21,52	58,10

Available in the colours: B-G-E-T-C-A. The code of the selected colour must be added to the article code. E.g.: PC 8055AL... (colore Bianco) PC 8055ALB.

EXAMPLES OF LAYING (for laying instructions, see above)

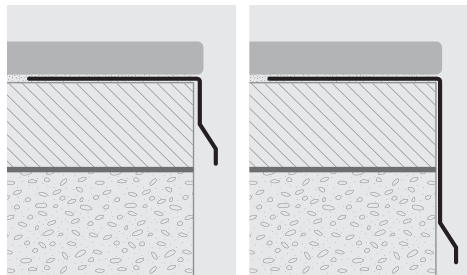

COLOURS

B - White (RAL 9010)	G - Gray (RAL 7038)	A - Anthracite grey - (no RAL)
----------------------	---------------------	--------------------------------

AVAILABLE

C - Corten	E - Beige (RAL 1019)	T - Dark Brown (RAL 8019)
------------	----------------------	---------------------------

News 2015

PROTERRACE PC

VARNISHED/COATED ALUMINIUM

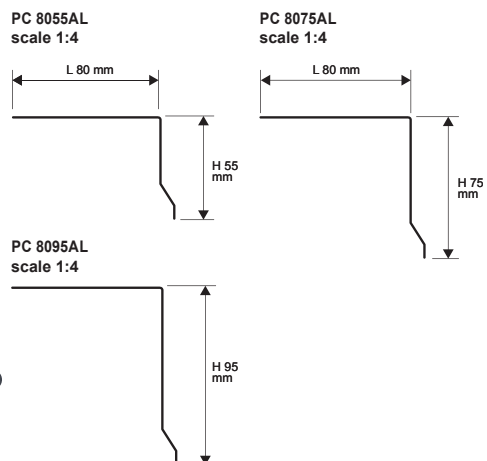

OUTSIDE CORNERS and JOINTS

VARNISHED/COATED ALUMINIUM

OUTSIDE CORNERS - pack. 10 Pcs

Article	€/Pc	€/pack.
AEPC 55AL...	25,26	252,60
AEPC 75AL...	25,26	252,60
AEPC 95AL...	25,26	252,60

Available in the colours: B-G-E-T-C-A. The code of the selected colour must be added to the article code. E.g.: AEPC 55AL... (colour White) AEPC 55ALB.

JOINTS - pack. 10 Pcs

Article	€/Pc	€/pack.
GINC 55AL...	4,88	48,80
GINC 75AL...	4,88	48,80
GINC 95AL...	4,88	48,80

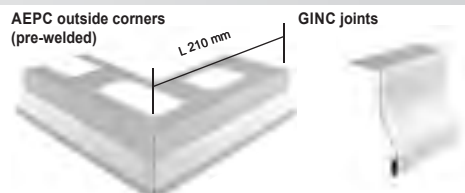

Prices are referred to whole packs. 10% increase for minimum orders of 10 pcs. 20% increase for orders of less than 10 pcs.

PROTERRACE PTER

STAINLESS STEEL AISI 304/1.4301-V2A

PTER 8042AC
scale 1:4

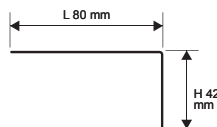

PTER 8055AC
scale 1:4

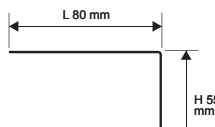

PTER 8075AC
scale 1:4

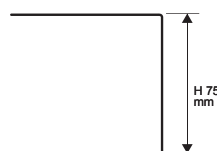

PTER 8095AC
scale 1:4

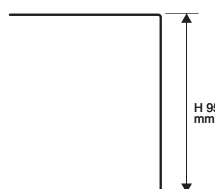

PROTERRACE PTER in stainless steel AISI 304/1.4301-V2A is a range of edging L-shape profiles for finishing and protecting the concrete front edges of terraces and balconies. It can be laid flush with or detached from the screed according to whether the tiles are laid flush with or protruding from the screed. Available in 4 sizes with standard punched base (width 80 mm) and heights 42, 55, 75 and 95 mm. Prewelded outside and corner joints as well as corner linking elements also available to join the profile longitudinally.



POLISHED STAINLESS STEEL AISI 304/1.4301-V2A with protective film - bar length 2,7 LM - pack. 10 Pcs - 27 LM

Article	L x H mm	€/LM	€/Pc
PTER 8042AC	80 x 42	22,51	60,78
PTER 8055AC	80 x 55	24,42	65,93
PTER 8075AC	80 x 75	27,66	74,68
PTER 8095AC	80 x 95	31,73	85,67

EXAMPLES AND INSTRUCTIONS FOR LAYING METHODS

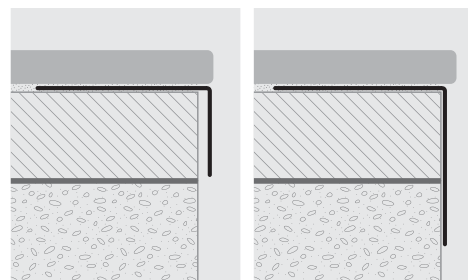

1. Choose the PROTERRACE PTER of the type and finish suitable for the thickness of the screed. 2. Lay the PROTERRACE PTER along the edge of the surface to be tiled at the same time as laying the tiles and using the same adhesive. 3. For a perfect waterproofing, below the glue it is recommended to use an elastic membrane product (e.g. Mapelastoc - Rasoeleastic - Elastocem - Elastomalta - Idrobuilt) and our sheathing/waterproof membrane/drainage PROFILMAT and/or PRODRAIN.

OUTSIDE CORNERS and JOINTS

POLISHED STAINLESS STEEL AISI 304/1.4301-V2A

AEPR outside corners
(pre-welded)

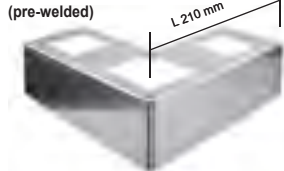

GIN joints



OUTSIDE CORNERS - pack. 10 Pcs

Article	€/Pc	€/pack.
AEPR 42AC	30,30	303,00
AEPR 55AC	30,30	303,00
AEPR 75AC	30,30	303,00
AEPR 95AC	30,30	303,00

JOINTS - pack. 10 Pcs

Article	€/Pc	€/pack.
GIN 42AC	5,55	55,50
GIN 55AC	5,55	55,50
GIN 75AC	5,55	55,50
GIN 95AC	5,55	55,50

PROTERRACE PTER

VARNISHED/COATED ALUMINIUM

PTER 8042AL...
scale 1:4

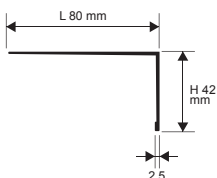

PTER 8055AL...
scale 1:4

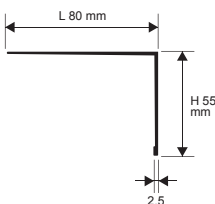

PTER 8075AL...
scale 1:4

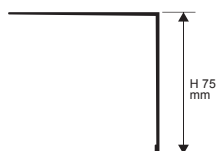

PTER 8095AL...
scale 1:4

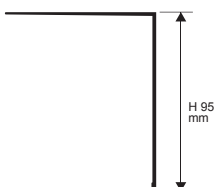

PROTERRACE PTER in painted aluminium is a range of edging L-shape profiles for finishing and protecting the concrete front edges of terraces and balconies. It can be laid flush with or detached from the screed according to whether the tiles are laid flush with or protruding from the screed. Available in 4 sizes with standard punched base (width 80 mm) and heights 42, 55, 75 and 95 mm. Prewelded outside and corner joints as well as corner linking elements also available to join the profile longitudinally.

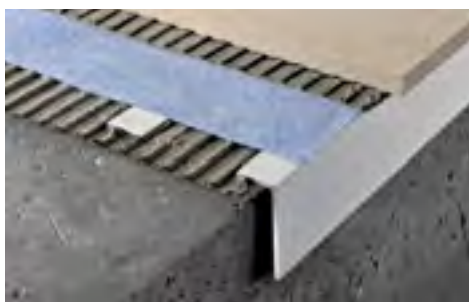

EXAMPLES OF LAYING (for laying instructions, see above)

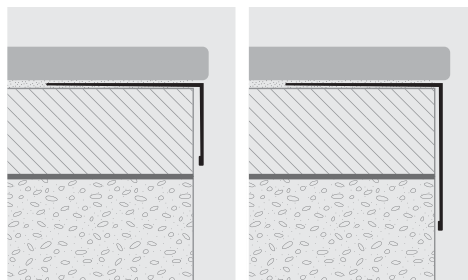

VARNISHED/COATED ALU. - bar length 2,7 LM - pack. 20 Pcs - 54 LM

Article	L x H mm	€/LM	€/Pc
PTER 8042AL...	80 x 42	12,94	34,94
PTER 8055AL...	80 x 55	15,15	40,91
PTER 8075AL...	80 x 75	17,36	46,87
PTER 8095AL...	80 x 95	19,56	52,81

Available in the colours: B-G-E-T-C-A. The code of the selected colour must be added to the article code. E.g.: PTER 8042AL... (colour White) PTER 8042ALB.

COLOURS

B - White (RAL 9010)	G - Gray (RAL 7038)	A - Anthracite grey - (no RAL)
----------------------	---------------------	--------------------------------

AVAILABLE

C - Corten	E - Beige (RAL 1019)	T - Dark Brown (RAL 8019)
------------	----------------------	---------------------------

News 2015

OUTSIDE CORNERS and JOINTS

VARNISHED/COATED ALUMINIUM

AEPR outside corners
(pre-welded)

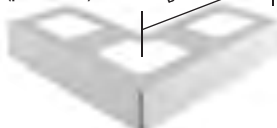

GIN joints



OUTSIDE CORNERS - pack. 10 Pcs

Article	€/Pc	€/pack.
AEPR 42AL...	20,13	201,30
AEPR 55AL...	20,13	201,30
AEPR 75AL...	20,13	201,30
AEPR 95AL...	20,13	201,30

JOINTS - pack. 10 Pcs

Article	€/Pc	€/pack.
GIN 42AL...	4,62	46,20
GIN 55AL...	4,62	46,20
GIN 75AL...	4,62	46,20
GIN 95AL...	4,62	46,20

Available in the colours: B-G-E-T-C-A. The code of the selected colour must be added to the article code. E.g.: AEPR 42AL... (colour White) AEPR 42ALB.

Prices are referred to whole packs. 10% increase for minimum orders of 10 pcs. 20% increase for orders of less than 10 pcs.

PRODESO HEAT SYSTEM

© 2011 All rights reserved by Progress Profiles. Printed in Italy



profiles, membranes and
drains for terraces and balconies

Revolutionary patented system, uncoupling, crack isolation and waterproofing membrane, for electrical floor heating

PRODESO HEAT SYSTEM by Progress

Profiles combines the benefit of an underlayment membrane with the comfort and convenience of electrical floor heating.

The **PRODESO HEAT** Membrane can be installed over the entire subfloor as an uncoupling, crack isolating and waterproofing membrane.



The **PRODESO HEAT** Cable is then installed in the areas where heat is required. Once the Heat Cable is installed you can begin tiling immediately, no waiting is necessary.

Install an underlayment membrane, the floor heat and tile all in the same day.

PRODESO HEAT SYSTEM will add only 5.5mm to your overall installation. That's less than a 1/4 inch, which is considerably less than any previously used systems.

The patented **PRODESO HEAT SYSTEM** by Progress Profiles allows you to have the comfort and convenience of under floor electrical radiant heating without the unnecessary added time and cost of previously used systems.

The innovative and Patented **PRODESO HEAT SYSTEM** by Progress Profiles is a time saving, cost effective system to install a warm and comforting floor. The electric heating cable can be installed in the grooves of our patented membrane just where heat is desired and recommended.

PRODESO HEAT SYSTEM thermostat allows you to program and control your floor heat cycles to optimize comfort and minimize operating costs. The pleasure of under floor heat where you want it, when you want it.

The **PRODESO HEAT SYSTEM** is an easy to install and cost effective solution.

The advantages of a radiant heat floor system have long been known but the PRODESO HEAT SYSTEM has game changing advantages.

- Thanks to the uncoupling and crack isolating properties of the **PRODESO HEAT** membrane, it's possible to install tile and floor heating over a variety of difficult substrates such as Plywood, Cement Slabs etc.
- Thanks to the uncoupling and crack isolating properties of **PRODESO HEAT** membrane, it's possible to eliminate some of the otherwise necessary expansion joints in your installation.
- With its low profile design, the height of the membrane is only 5.5 mm (1/4 inch) **PRODESO HEAT** is the perfect solution for remodeling projects where the new floor needs to transition over an existing surface.
- The low overall weight of the system makes it the perfect choice for applications when load bearing capacity of the subfloor is a limitation.
- Low thermal inertia. Tiles are installed directly on top of the heating cable. The heat will transfer rapidly and efficiently to the above tile for instant comfort and enjoyment.
- The benefit of choosing exactly where to install your heat areas will allow you to maximize your return on investment. Heat where you want it, when you want it, reducing the operating cost of the overall system while increasing the comfort and value of your home.
- Cost effective/time saving installation, coupled with the efficiency and safety of electric radiant heat make **PRODESO HEAT SYSTEM** the obvious choice.
- **PRODESO HEAT SYSTEM** does not require any maintenance over time.



© 2011 All rights reserved by Progress Profiles. Printed in Italy

LAYING'S SECTION OF PRODESO HEAT SYSTEM

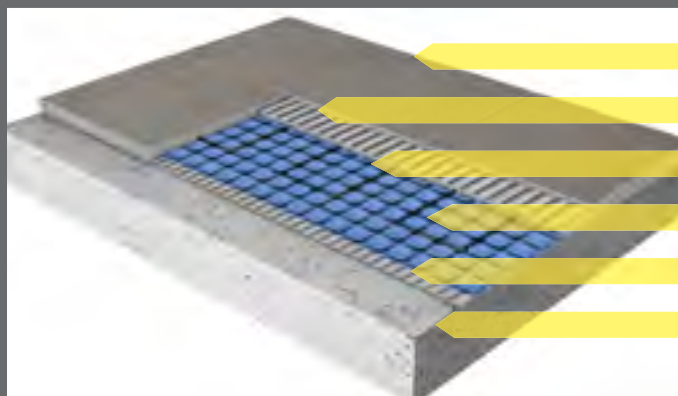

- 1 Ceramic or Porcelain Tiles
- 2 Thin-set/Adhesive
- 3 PRODESO HEAT MEMBRANE
- 4 PRODESO HEAT CABLE
- 5 Thin-set/Adhesive
- 6 Mortar or Plywood /OSB

PRODESO HEAT MEMBRANE

is a polypropylene uncoupling crack isolation waterproofing membrane, with rounded square shaped reliefs. These reliefs form a channel specially designed to embed and hold the Prodeso Heat Cable. Prodeso Heat Membrane unique design allows for:

- Flexible heating zone selection
- Cost and time saving installation
- Waterproofing
- Uncoupling crack isolation
- Vapor management
- Support load distribution
- Small height increase 5.5mm (1/4 inch)

PRODESO HEAT CABLE

is a heating cable designed to work in conjunction with Prodeso Heat Membrane. Cable separation 2 1/2" & 3 3/4" depending on the cable power rating.



PRODESO HEAT THERMOSTAT KIT

is a digital floor thermostat kit with cable floor sensor



PRODESO HEAT MEMBRANE

UNCOUPLING WATERPROOFING MEMBRANE FOR ELECTRIC HEATING - 15/5 M²

Article		Width. roll L x H ML	Tot. m ²	Price €/ m ²	Price €/ Roll
⊕ PDESH 151/E	Prodeso Heat Membrane	1 m x 15 m	15	17,50	262,50
⊕ PDESH 051/E	Prodeso Heat Membrane	1 m x 5 m	5	17,50	87,50 *

* = Upon request

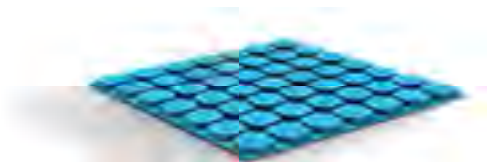

PRODESO HEAT CABLE

Article	Length / lm Roll	Area m ²	Total power W	Price €/ Roll
230 Volts				
⊕ PDHCB 12	12,07 lm	1,1	150	161,00
⊕ PDHCB 17	17,66 lm	1,6	225	189,50
⊕ PDHCB 23	23,77 lm	2,2	300	212,00
⊕ PDHCB 29	29,87 lm	2,7	375	249,50
⊕ PDHCB 35	35,97 lm	3,3	450	287,00
⊕ PDHCB 41	41,56 lm	3,8	525	319,50
⊕ PDHCB 47	47,67 lm	4,4	600	366,50
⊕ PDHCB 53	53,77 lm	5,0	675	406,45
⊕ PDHCB 59	59,87 lm	5,5	750	435,05
⊕ PDHCB 71	71,57 lm	6,6	900	501,00
⊕ PDHCB 83	83,77 lm	7,7	1050	587,15
⊕ PDHCB 95	95,47 lm	8,8	1200	668,50
⊕ PDHCB 107	107,67 lm	10,0	1350	734,10
⊕ PDHCB 119	119,37 lm	11,1	1500	799,25
⊕ PDHCB 143	143,27 lm	13,3	1800	877,20
⊕ PDHCB 179	179,37 lm	16,6	2250	944,50

PRODESO HEAT THERMOSTAT KIT

PRODESO HEAT DIGITAL FLOOR THERMOSTAT KIT WITH CABLE FLOOR SENSOR

Article	Price €/ Kit
⊕ PDHTSK 230V	237,50



⊕ = News

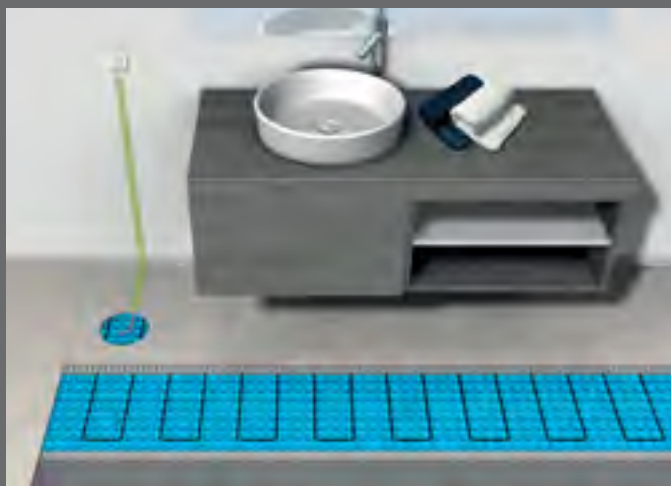

PRODESO HEAT SYSTEM CAN BE USED AS PRIMARY OR SECONDARY HEAT SOURCE IN A VARIETY OF APPLICATIONS.

Commercial Lobby / Reception / Conference Room / Office / Bathrooms / Restaurant / SPA / Pool Surroundings / Reception Hall.

Residential Foyers / Kitchen / Bathroom / Shower / Living Room / Dining Room / Pools Surroundings / Basements / Home Theater / Man-Cave.

The applications are endless. Wherever heat and comfort are desired, **PRODESO HEAT SYSTEM** is the solution.

PRODESO

UNCOUPLING & WATERPROOFING MEMBRANE

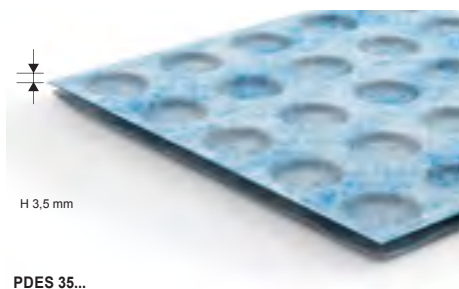

PRODESO is a membrane in low density polyethylene provided with circular cavities and coated on both sides of a non-woven polypropylene thermowelded which ensures the adhesion to the support and the anchoring of the floor.

UNCOUPLING & WATERPROOFING MEMBRANE

thickness **H 3,5 mm**

Article	H Roll (LM)	L Roll (LM)	Rolls x Pallet	€/LM	€/Roll	€/Pallet
PDES 3530	1	30	8	15,10	453,00	3.624,00

AREA OF USE

• Use

Desolidarisation and waterproofing of substrates before laying ceramic floor and natural stone. Cement subfloor even if fissured and not completely seasoned aged, ceramic floors, terrazzo, existing natural stone surfaces anchored to the substrate, not fully seasoned aged concrete and wooden substrates. **PRODESO** is resistant to saline solutions, acids and alkalis, alcohol and oils. For application not included above contact our technical office.

• Don't use

On bitumen membranes/coverings, on top of lightweight insulating rooftop panels or lightweight cement substrate.

WARNINGS

Do not lay tile size less than 5 x 5 cm. The technological and applicative details can be found on the technical sheet **WATERSTOP SYSTEM**. For matters not covered in the technical sheet **WATERSTOP SYSTEM**, consult the technical department.

PROBAND 150/250

ROLLS IN HDPE AND PP



PROBAND 150/250 is a waterproofing elastic polyethylene ribbon with polypropylene nonwoven on both side that guarantees high adhesion to the support.

ROLLS IN HDPE AND PP - thickness 0,40 mm

Article	Roll width H mm x L LM	Rolls/ Pack	€/LM	€/Roll	€/Pack
PRBPE 1505	150 x 5	10	3,55	17,75	177,50
PRBPE 1530	150 x 30	6	2,78	83,40	500,40
PRBPE 2505	250 x 5	5	5,43	27,15	135,75
PRBPE 2530	250 x 30	3	4,70	141,00	423,00

AREA OF USE

• Use

Terraces, balconies and external surfaces of any dimension. To realize waterproofing joints between floor and wall and along the joints between two sheet of **PROFOIL** and with **WATERSTOP SYSTEM**.

• Don't use

On bituminous membranes/coverings, over insulating panels and lightweight cement substrate. Don't use with solvent based adhesive.

WARNINGS

Store in a cool and dry place avoiding direct sunlight and sources of heat.
Read the data sheet before applying; in case of special applications call the technical department.

PREFORMED CORNERS

Inner and outer preformed corners in polyethylene with polypropylene nonwoven on both side that guarantees high adhesion to the support.

PREFORMED CORNERS IN HDPE E PP

thickness **0,40 mm**

Article	H x L mm	Pcs/Pack	€/Pc	€/Pack
PRBI	150 X 150	10 Pz	10,21	102,10
PRBE	150 X 150	10 Pz	10,21	102,10

AREA OF USE

• Use

Terraces, balconies and external surfaces of any dimension, bathroom, showers, swimming pools and tubs. To realize inner and outer corners with **PROFOIL** and outer and inner corners in **WATERSTOP SYSTEM**.

• Don't use

On bituminous coverings, over insulating panels and lightweight cement substrate. Don't use with solvent based adhesive.

WARNINGS

Store in a cool and dry place avoiding direct sunlight and sources of heat.
Read the data sheet before applying; in case of special applications call the technical department.

PROFOIL is a waterproofing elastic polyethylene membrane with polypropylene nonwoven on both side that guarantees high adhesion to the support.

PROFOIL

ROLLS IN HDPE AND PP

AREAS OF USE

• Use

waterproofing of substrates and vertical structures before coverings in ceramic and stone materials are laid in areas subject to occasional contact with water like bathrooms and kitchens, with high vapor pressure like saunas and Turkish baths and with permanent contact with water also in pressure like swimming pools and tubs. Screed without cracks and completely cured, ceramic floors and natural stones anchored to the substrate, concrete completely cured and wood supports.

• Don't use

On bituminous coverings, over insulating panels and lightweigh cement substarte, on terraces and balconies.

WARNINGS

Store in a cool and dry place avoiding direct sunlight and sources of heat.

Read the data sheet before applying; in case of special applications call the technical department.

ROLLS IN HDPE AND PP - thickness 0,5 mm

Article	Roll width H x L LM	total m ²	€/m ²	€/Roll
PFLO 0405	1 x 5	5	17,50	87,50
PFLO 0430	1 x 30	30	13,15	394,50

PROBAND 150/250 is a waterproofing elastic polyethylene ribbon with polypropylene nonwoven on both side that guarantees high adhesion to the support.

AREA OF USE

• Use

Terraces, balconies and external surfaces of any dimension. To realize waterproofing joints between floor and wall and along the joints between two sheet of **PROFOIL** and with **WATERSTOP SYSTEM**.

• Don't use

On bituminous coverings, over insulating panels and lightweigh cement substarte. Don't use with solvent based adhesive.

WARNINGS

Store in a cool and dry place avoiding direct sunlight and sources of heat.

Read the data sheet before applying; in case of special applications call the technical department.

ROLLS IN HDPE AND PP - thickness 0,40 mm

Article	Roll width H mm x L LM	Rolls/ Pack	€/LM	€/Roll	€/Pack
PRBPE 1505	150 x 5	10	3,55	17,75	177,50
PRBPE 1530	150 x 30	6	2,78	83,40	500,40
PRBPE 2505	250 x 5	5	5,43	27,15	135,75
PRBPE 2530	250 x 30	3	4,70	141,00	423,00

PROBAND 150/250

ROLLS IN HDPE AND PP



PREFORMED CORNERS AND PIPE COLLAR

Inner and outer preformed corners and pipe collar in polyethylene with polypropylene nonwoven on both side that guarantees high adhesion to the support.

PREFORMED CORNERS AND PIPE COLLAR IN HDPE E PP

- thickness 0,40 mm

Article	H x L mm	Pcs/Pack	€/Pc	€/Pack
PRBI (interno)	150 X 150	10 Pz	10,21	102,10
PRBE (esterno)	150 X 150	10 Pz	10,21	102,10
PRBT (tassello)	125 X 125	10 Pz	8,20	82,00

AREA OF USE

• Use

Terraces, balconies and external surfaces of any dimension, bathroom, showers, swimming pools and tubs. To realize inner and outer corners and pipe collar with **PROFOIL** and outer and inner corners in **WATERSTOP SYSTEM**.

• Don't use

On bituminous coverings, over insulating panels and lightweigh cement substarte. Don't use with solvent based adhesive.

WARNINGS

Store in a cool and dry place avoiding direct sunlight and sources of heat.

Read the data sheet before applying; in case of special applications call the technical department.



OUTSIDE CORNER



INSIDE CORNER



PIPE COLLAR

PRODRAIN 10

DRAINAGE MEMBRANE

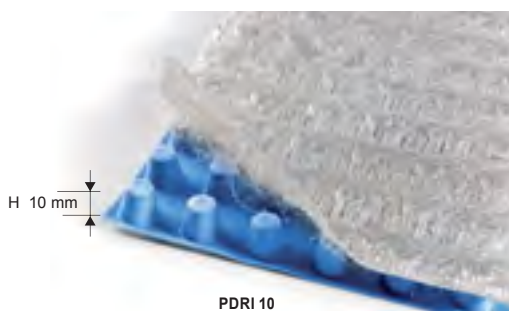

PRODRAIN 10 is a drainage membrane formed from a sheet of high density polyethylene (HDPE) blue, provided with reliefs truncated conical to base circular, surmounted by a non-woven polypropylene gray water permeable.

DRAINAGE MEMBRANE

thickness **10 mm** - Total **12,0 m²** - **6 rolls per pallet = 72 m²**

Article	H Roll (LM)	L Roll (LM)	Rolls/Pallet	€/m²	€/Roll	€/Pallet
PDRI 10	0,96	12,5	6	12,09	145,08	870,48

AREA OF USE

• Use

Outside on floors sloped properly waterproofed such as terraces and balconies and in contact with vertical waterproof structures such as foundation walls before filling the trench. Resistant to saline solutions, acids and alkalis, alcohol and oils. In case there are particular products consult the technical department.

• Don't use

On floors not waterproofed or waterproofing of that have no adequate slope for drainage of the water drained. How phono absorbent pad and thermal insulation.

WARNINGS

Store in cool, dry place avoiding direct sunlight and heat sources.

See the data sheet prior to application in the case of special applications, we recommend that you consult the technical department.

PROBAND SE

WATERPROOF TAPE IN SEBS



WATERPROOF TAPE IN SEBS

Roll **50 ML**

Article	Roll width H x L LM	€/LM	€/Roll 50 LM
PRBSE	0,12 x 50	4,62	231,00

AREA OF USE

• Use

Waterproofing of floor joints and perimeter joints connecting wall-floor on balconies, terraces and exterior surfaces of any size, tubs, canals and civil and industrial works.

• Don't use

With **WATERSTOP SYSTEM**.

On bituminous coverings.

With adhesives containing solvents.

PRODUCT APPLICATION



1. Apply a thin layer of at least 1 mm of thickness of sealant **PROBAND KOLL** along the wall-floor perimeter joints to a width of at least 15 cm.



2. Apply **PROBAND SE**, after cutting to length, with the net in full-height on the layer of sealant still wet.



3. Exert a strong pressure and to smooth with a smooth spatula to favor the complete drowning of the net in the sealant and to avoid the formation of folds of the tape.

WARNINGS

Preserve avoiding direct sunlight and heat sources.

See the data sheet prior to application in the case of special applications, we recommend that you consult the technical department.

PRODRIP is a perimetral drain in ASA (Modified ABS), equipped with junction wall-floor covered with nonwoven in polypropylene to ensure sealing in the system **WATERSTOP SYSTEM**.

PERIMETRAL DRAIN

Pack of 4 pcs. - Pack per Pallet = 192

Article	Colour	Pcs/Pack	€/Pc	€/Pack
PDRP	Gray	4	19,00	76,00

AREA OF USE

• Use

balconies, terraces and external horizontal surfaces of any size, creation of drains in the system **WATERSTOP SYSTEM**.

• Don't use

Under cement substrate and as vertical drain.

WARNINGS

Do not heat with direct flames.

Consult the data sheet prior to application in the case of special applications, we recommend that you consult the technical department.

PROBAND KOLL is a monocomponent sealant in very low emissions of volatile organic compounds for sealing waterproof with high adhesion of the **PROBAND** tape waterproofing

MONOCOMPONENT SEALANT

Bucket of 20Kg Bucket per Pallet = 30Kg per Pallet 600Kg

Article	Colours	Bucket Kg.	€/Kg.	€/Bucket	€/Pallet
PRBKL	Red	20	7,50	150,00	4.500,00

AREA OF USE

• Use

Sealant for sealing of the waterproof elastic tape "PROBAND" in the system **WATERSTOP SYSTEM** Balconies, terraces, bathrooms, kitchens, saunas and external surfaces of any size.

• Don't use

Of bituminous coverings, on top of lightweight insulating rooftop panels or lightweight cement substrate.

WARNINGS

Store in cool, dry place avoiding direct sunlight and heat sources.

See the data sheet prior to application in the case of special applications, we recommend that you consult the technical department.

PROBAND BU is a high adhesion butyle adhesive tape coated on one side with non-woven polypropylene and alkali resistant.

BUTYLE TAPE - thickness 1 mm

Article	H Roll (mm)	L Roll (LM)	Rolls/ Pack	€/LM	€/Roll	€/Pack
PRBBU 7515	75	15	2	2,98	44,70	89,40

AREA OF USE

• Use

Balconies, terraces and external surfaces of any size. Realization of perimeter junctions in the system **WATERSTOP SYSTEM** in the case of supports in bitumen, PVC, wood, polycarbonate, glass, plastic and metal.

• Don't use

On dirty, inconsistent and wet surfaces.

WARNINGS

Store the product in a dry place and avoid direct sunlight and heat sources.

See the data sheet prior to application in the case of special applications, we recommend that you consult the technical department.

PROBAND FIX is a silicon based moisture-curing sealant with high adhesion and elasticity. **PROBAND FIX** is used to waterproof and seal the bond between **PROBAND** and **PROFOIL**, for junction of **PROBAND** at fixtures and sheet metal in general.

SEALANT MONOCOMPONENT WATERPROOF

Pack of 12 cartridges

Article	Colours	Cartridge	€/Pc	€/Pack
PRBFXB	White	290	13,50	162,00
PRBFXG	Gray	290	13,50	162,00

AREA OF USE

• Use

Balconies, terraces, bathrooms, kitchens, saunas, swimming pools and exterior surfaces of any size.

• Don't use

On bitumen membranes.

To seal **PROBAND** with **PRODESO**.

WARNINGS

Store in cool, dry place avoiding direct sunlight and heat sources.

See the data sheet prior to application in the case of special applications, we recommend that you consult the technical department.

PRODRIP

PERIMETRAL DRAIN

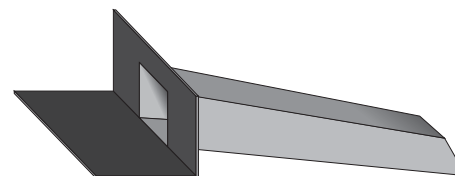

PROBAND KOLL

MONOCOMPONENT SEALANT



PROBAND BU

BUTYLE TAPE



PROBAND FIX

SEALANT MONOCOMPONENT WATERPROOF



For more details see page 250.





PROSHOWER is a water collecting duct system with floor flush overall height of 85 mm, entirely made of AISI 304/1.4301 – V2A steel, available in 5 different lengths and equipped with 6 different stainless steel finish grids. After the production cycle, **PROSHOWER** undergoes electro-polishing and then passivation to make the product fully corrosion-resistant. Its low thickness combined with the fully adjustable siphon, its special modularity and high number of finish grids makes it a very appreciated solution under a technical and aesthetic aspect.



DUCT BODY MADE OF AISI 304 STAINLESS STEEL

Article	Description	Pc/Pck	€/Pc
PSHWDL 70	PROSHOWER BASE L W 70 x 8 cm	1	325,00
PSHWDL 80	PROSHOWER BASE L W 80 x 8 cm	1	345,00
PSHWDL 90	PROSHOWER BASE L W 90 x 8 cm	1	365,00
PSHWDL 100	PROSHOWER BASE L W 100 x 8 cm	1	385,00
PSHWDL 120	PROSHOWER BASE L W 120 x 8 cm	1	435,00

On request available vertical Outlet drain. (Reference code: PSHWDV...)

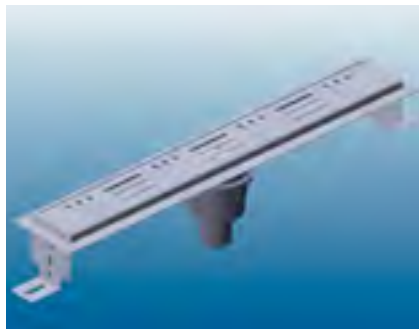

PROSHOWER BASE L

SUPER POLISHED STAINLESS STEEL
AISI 304/1.4301-V2A

PSHWDL 70 / 80 / 90 / 100 / 120

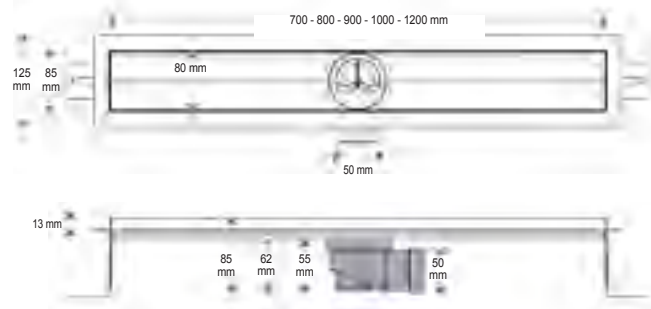

profiles, membranes and
drains for terraces and balconies

PROSHOWER TILE-LINE

SUPER POLISHED STAINLESS STEEL
AISI 304/1.4301-V2A

TILE

PSHWT 70/80/90/100/120

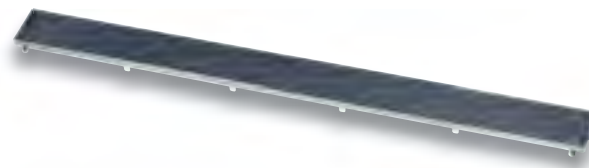

LINE

PSHWL 70/80/90/100/120



Article	Description	Pc/Pck	€/Pc
PSHWT 70	PROSHOWER TILE - STEEL - Grid L 70 x 8 cm made of AISI 304 stainless steel	1	125,00
PSHWT 80	PROSHOWER TILE - STEEL - Grid L 80 x 8 cm made of AISI 304 stainless steel	1	130,00
PSHWT 90	PROSHOWER TILE - STEEL - Grid L 90 x 8 cm made of AISI 304 stainless steel	1	135,00
PSHWT 100	PROSHOWER TILE - STEEL - Grid L 100 x 8 cm made of AISI 304 stainless steel	1	150,00
PSHWT 120	PROSHOWER TILE - STEEL - Grid L 120 x 8 cm made of AISI 304 stainless steel	1	165,00

Provided only combined with L. Proshower Base L.

Article	Description	Pc/Pck	€/Pc
PSHWL 70	PROSHOWER LINE - STEEL- Grid L 70 x 8 cm made of AISI 304 stainless steel	1	125,00
PSHWL 80	PROSHOWER LINE - STEEL- Grid L 80 x 8 cm made of AISI 304 stainless steel	1	130,00
PSHWL 90	PROSHOWER LINE - STEEL- Grid L 90 x 8 cm made of AISI 304 stainless steel	1	135,00
PSHWL 100	PROSHOWER LINE - STEEL- Grid L 100 x 8 cm made of AISI 304 stainless steel	1	150,00
PSHWL 120	PROSHOWER LINE - STEEL- Grid L 120 x 8 cm made of AISI 304 stainless steel	1	165,00

Provided only combined with L. Proshower Base L.

Prices are referred to whole packs. 10% increase for minimum orders of 10 pcs. 20% increase for orders of less than 10 pcs.

PROSHOWER DESIGN - STRIPS - GRILL - SQUARE

SUPER POLISHED STAINLESS STEEL
AISI 304/1.4301-V2A



DESIGN



PSHWD 70/80/90/100/120

STRIPS



PSHWST 70/80/90/100/120

GRILL



PSHWGR 70/80/90/100/120

SQUARE



PSHWSQ 70/80/90/100/120

Article	Description	Pc/Pck	€/Pc
PSHWD 70	PROSHOWER DESIGN - STEEL- Grid L 70 x 8 cm made of AISI 304 stainless steel	1	125,00
PSHWD 80	PROSHOWER DESIGN - STEEL- Grid L 80 x 8 cm made of AISI 304 stainless steel	1	130,00
PSHWD 90	PROSHOWER DESIGN - STEEL- Grid L 90 x 8 cm made of AISI 304 stainless steel	1	135,00
PSHWD 100	PROSHOWER DESIGN - STEEL- Grid L 100 x 8 cm made of AISI 304 stainless steel	1	150,00
PSHWD 120	PROSHOWER DESIGN - STEEL- Grid L 120 x 8 cm made of AISI 304 stainless steel	1	165,00

Provided only combined with L. Proshower Base L.

Article	Description	Pc/Pck	€/Pc
PSHWST 70	PROSHOWER STRIPS - STEEL- Grid L 70 x 8 cm made of AISI 304 stainless steel	1	125,00
PSHWST 80	PROSHOWER STRIPS - STEEL- Grid L 80 x 8 cm made of AISI 304 stainless steel	1	130,00
PSHWST 90	PROSHOWER STRIPS - STEEL- Grid L 90 x 8 cm made of AISI 304 stainless steel	1	135,00
PSHWST 100	PROSHOWER STRIPS - STEEL- Grid L 100 x 8 cm made of AISI 304 stainless steel	1	150,00
PSHWST 120	PROSHOWER STRIPS - STEEL- Grid L 120 x 8 cm made of AISI 304 stainless steel	1	165,00

On request

Article	Description	Pc/Pck	€/Pc
PSHWGR 70	PROSHOWER GRILL - STEEL - Grid L 70 x 8 cm made of AISI 304 stainless steel	1	125,00
PSHWGR 80	PROSHOWER GRILL - STEEL - Grid L 80 x 8 cm made of AISI 304 stainless steel	1	130,00
PSHWGR 90	PROSHOWER GRILL - STEEL - Grid L 90 x 8 cm made of AISI 304 stainless steel	1	135,00
PSHWGR 100	PROSHOWER GRILL - STEEL - Grid L 100 x 8 cm made of AISI 304 stainless steel	1	150,00
PSHWGR 120	PROSHOWER GRILL - STEEL - Grid L 120 x 8 cm made of AISI 304 stainless steel	1	165,00

On request

Article	Description	Pc/Pck	€/Pc
PSHWSQ 70	PROSHOWER SQUARE - STEEL - Grid L 70 x 8 cm made of stainless steel	1	125,00
PSHWSQ 80	PROSHOWER SQUARE - STEEL - Grid L 80 x 8 cm made of stainless steel	1	130,00
PSHWSQ 90	PROSHOWER SQUARE - STEEL - Grid L 90 x 8 cm made of stainless steel	1	135,00
PSHWSQ 100	PROSHOWER SQUARE - STEEL - Grid L 100 x 8 cm made of stainless steel	1	150,00
PSHWSQ 120	PROSHOWER SQUARE - STEEL - Grid L 120 x 8 cm made of stainless steel	1	165,00

On request

Prices are referred to whole packs. 10% increase for minimum orders of 10 pcs. 20% increase for orders of less than 10 pcs.

Article	Description	Pc/Pck	€/Pc
PSHANT 70	PROFOIL section and double sided tape 3 lm	1	19,00
PSHANT 80	PROFOIL section and double sided tape 3 lm	1	23,00
PSHANT 90	PROFOIL section and double sided tape 3 lm	1	27,00
PSHANT 100	PROFOIL section and double sided tape 3 lm	1	31,00
PSHANT 120	PROFOIL section and double sided tape 3 lm	1	36,00

Article	Description	Pc/Pck	€/Pc
PSHWRD 5040	50 to 40 mm polypropylene drain reduction	1	10,00

PROFOIL SECTION

HDPE E PP GUAINA



3 ml / lm

PROFOIL SECTION AND DOUBLE SIDED TAPE

DRAIN REDUCTION

POLYPROPYLENE



REDUCTION

KIT DE MONTAGE MODULAIRE

Article	Description	Pc/Pck	€/Pc
PSHWRD	Modular assembly kit to make drain ducts of any length	1	26,00



MODULAR ASSEMBLY KIT



MODULARITY



DRAIN



PROFOIL SECTION AND DOUBLE SIDED TAPE



PROSHOWER PROFILE

PROSHOWER PROFILE

STAINLESS STEEL
AISI 304 / 1.4301 – V2A

PSHWPACS ...DX/SX
scale 1:1

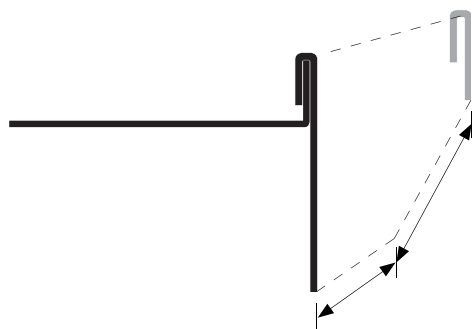
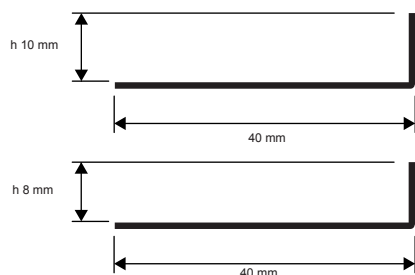
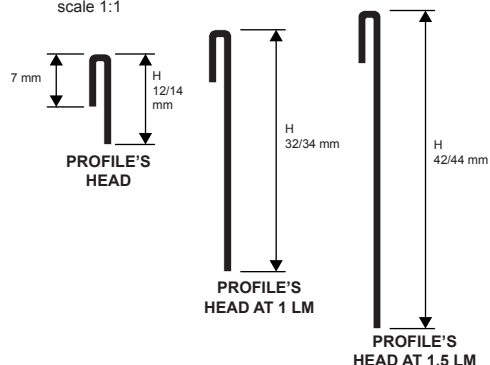

EXAMPLES AND INSTRUCTIONS FOR LAYING METHODS



1. Choose the right PROSHOWER PROFILE depending on the length of the planned shower; 2. Cut PROSHOWER PROFILE at the desired length and apply the adhesive on the substrate; 3. Press the anchoring flange of PROSHOWER PROFILE in the adhesive; 4. Lay the tiles, aligning them to the profile and leaving a 2mm joint; 5. Plaster the joint between the profile and the tiles, in order to avoid water stagnation.

PROSHOWER PROFILE is a profile in AISI 304 / 1.4301 – V2A satined stainless steel, which has been degreased and passivated, with adjustable length, conceived for the protection of floor edges and the joining of plane tiled surfaces to inclined tiled surfaces; consisting of two parts: the first is "L"-shaped and is available in the heights of 8 and 10mm and in the lengths of 100 and 150 cm; the second part has the shape of an elongated and pressed "C", has an exposed surface with a height sloping from 12 mm to 32 mm (for the 100 cm long version) or to 42 mm (for the 150 cm long version). The "C"-shaped part is laser-cut and its surface - apart from the last 12 cm long section, which is perfectly plane - has a 2% inclination. Thanks to its particular shape and to the different lengths/heights available **PROSHOWER PROFILE** can be used in any situation and fits with any kind of flooring.



PROSHOWER PROFILES IN STAINLESS STEEL AISI 304/1.4301-V2A DEGREASED AND PASSIVATED thermo packed - Pack 60 Pc - RIGHT

Article	h mm	L LM	H mm	€/Pc
PSHWPACS 0810DX	8	1	12-32	59,50
PSHWPACS 1010DX	10	1	14-34	60,50
PSHWPACS 0815DX	8	1,5	12-42	72,50
PSHWPACS 1015DX	10	1,5	14-44	73,50

PROSHOWER PROFILES IN STAINLESS STEEL AISI 304/1.4301-V2A DEGREASED AND PASSIVATED thermo packed - Pack 60 Pc - LEFT

Article	h mm	L LM	H mm	€/Pc
PSHWPACS 0810SX	8	1	12-32	59,50
PSHWPACS 1010SX	10	1	14-34	60,50
PSHWPACS 0815SX	8	1,5	12-42	72,50
PSHWPACS 1015SX	10	1,5	14-44	73,50



Article	Description	Pc/Pck	€/Pc
PSHWDS 50	PROSHOWER DRAIN L- side drain with siphon with 50 mm diameter and fitting section	1	115,00

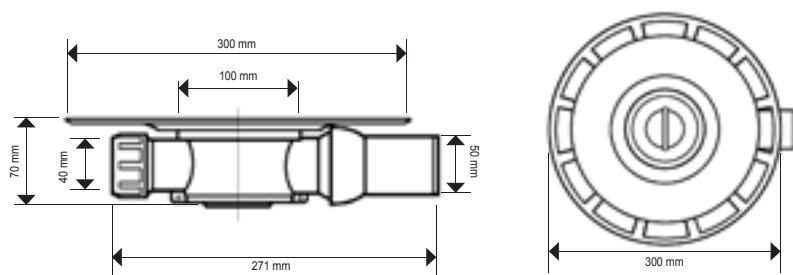

PROSHOWER DRAIN L

PP



PROSHOWER DRAIN L

Article	Description	Pc/Pck	€/Pc
PSHWDQ 10	PROSHOWER DRAIN – SQUARE 10 x 10 Grid holder with stainless steel base	1	45,00

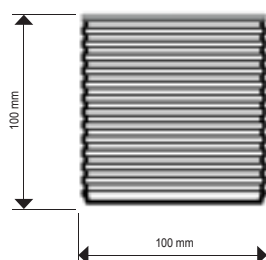

PROSHOWER DRAIN SQUARE

STAINLESS STEEL



PROSHOWER DRAIN - SQUARE

Article	Description	Pc/Pck	€/Pc
PSHWDG 93	PROSHOWER DRAIN 93 x 93 Grid, Fusion for grid holder	1	45,00

PROSHOWER DRAIN

STAINLESS STEEL



PROSHOWER DRAIN

Article	Description	Pc/Pck	€/Pc
PSHWDB 100	PROSHOWER DRAIN EXTEND Vertical and side drain extension with flange	1	100,00

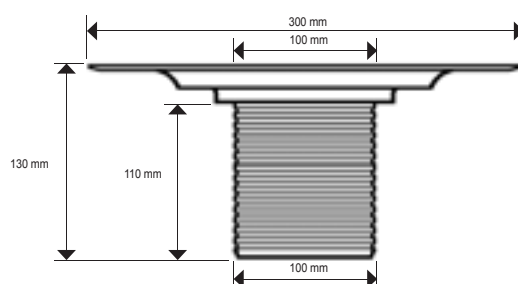

PROSHOWER DRAIN EXTEND

PP



PROSHOWER DRAIN EXTEND

Article	Description	Pc/Pck	€/Pc
PSHWDS 70	PROSHOWER DRAIN V vertical drain without siphon with 70 mm diameter	1	34,00

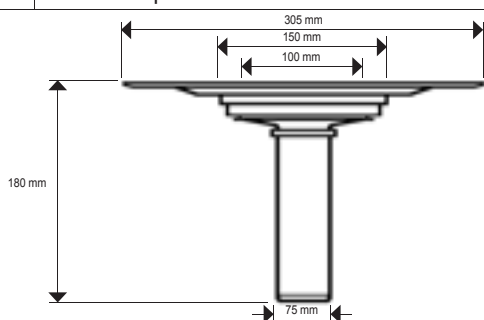

PROSHOWER DRAIN V

PP



PROSHOWER DRAIN V



PROFILES & SYSTEMS